

GEMÜ eSyLite spare parts

EN

Assembly instructions



All rights including copyrights or industrial property rights are expressly reserved.

Keep the document for future reference.

© GEMÜ Gebr. Müller Apparatebau GmbH & Co. KG
07.10.2024

Contents

1	General information	4
1.1	General information	4
1.2	Information	4
1.3	Symbols used	4
1.4	Definition of terms	4
1.5	Warning notes	4
2	Safety information	5
3	Replacement of emergency power supply module	5
4	Replacement of toothed gear	6

1 General information

1.1 General information

These assembly instructions are intended for the emergency power supply module and the toothed gear of a GEMÜ eSyLite actuator. The assembly instructions are shown here using an R629 as an example.

1.2 Information

- The descriptions and instructions apply to the standard versions. For special versions not described in this document the basic information contained herein applies in combination with any additional special documentation.
- Correct installation, operation, maintenance and repair work ensure faultless operation of the product.
- Should there be any doubts or misunderstandings, the German version is the authoritative document.
- Contact us at the address on the last page for staff training information.

1.3 Symbols used

The following symbols are used in this document:

Symbol	Meaning
●	Tasks to be performed
►	Response(s) to tasks
–	Lists

1.4 Definition of terms

Working medium

The medium that flows through the GEMÜ product.

Diaphragm size

Uniform seat size of GEMÜ diaphragm valves for different nominal sizes.

1.5 Warning notes

Wherever possible, warning notes are organised according to the following scheme:

SIGNAL WORD	
Possible symbol for the specific danger	Type and source of the danger <ul style="list-style-type: none"> ► Possible consequences of non-observance. ● Measures for avoiding danger.

Warning notes are always marked with a signal word and sometimes also with a symbol for the specific danger.

The following signal words and danger levels are used:

⚠ DANGER	
	Imminent danger! <ul style="list-style-type: none"> ► Non-observance can cause death or severe injury.

⚠ WARNING	
	Potentially dangerous situation! <ul style="list-style-type: none"> ► Non-observance can cause death or severe injury.

⚠ CAUTION	
	Potentially dangerous situation! <ul style="list-style-type: none"> ► Non-observance can cause moderate to light injury.

NOTICE	
	Potentially dangerous situation! <ul style="list-style-type: none"> ► Non-observance can cause damage to property.

The following symbols for the specific dangers can be used within a warning note:

Symbol	Meaning
	Electrostatic discharge!

2 Safety information

The safety information in this document refers only to an individual product. Potentially dangerous conditions can arise in combination with other plant components, which need to be considered on the basis of a risk analysis. The operator is responsible for the production of the risk analysis and for compliance with the resulting precautionary measures and regional safety regulations.

The document contains fundamental safety information that must be observed during commissioning, operation and maintenance. Non-compliance with these instructions may cause:

- Personal hazard due to electrical, mechanical and chemical effects.
- Hazard to nearby equipment.
- Failure of important functions.
- Hazard to the environment due to the leakage of dangerous substances.

The safety information does not take into account:

- Unexpected incidents and events, which may occur during installation, operation and maintenance.
- Local safety regulations which must be adhered to by the operator and by any additional installation personnel.

Prior to commissioning:

1. Transport and store the product correctly.
2. Do not paint the bolts and plastic parts of the product.
3. Carry out installation and commissioning using trained personnel.
4. Provide adequate training for installation and operating personnel.
5. Ensure that the contents of the document have been fully understood by the responsible personnel.
6. Define the areas of responsibility.
7. Observe the safety data sheets.
8. Observe the safety regulations for the media used.

During operation:

9. Keep this document available at the place of use.
10. Observe the safety information.
11. Operate the product in accordance with this document.
12. Operate the product in accordance with the specifications.
13. Maintain the product correctly.
14. Do not carry out any maintenance work and repairs not described in this document without consulting the manufacturer first.

In cases of uncertainty:

15. Consult the nearest GEMÜ sales office.

3 Replacement of emergency power supply module

NOTICE	
	<p>Electrostatic discharge!</p> <ul style="list-style-type: none"> ▶ Destruction of electronic components. ● Take the necessary ESD safety precautions during installation of the product.

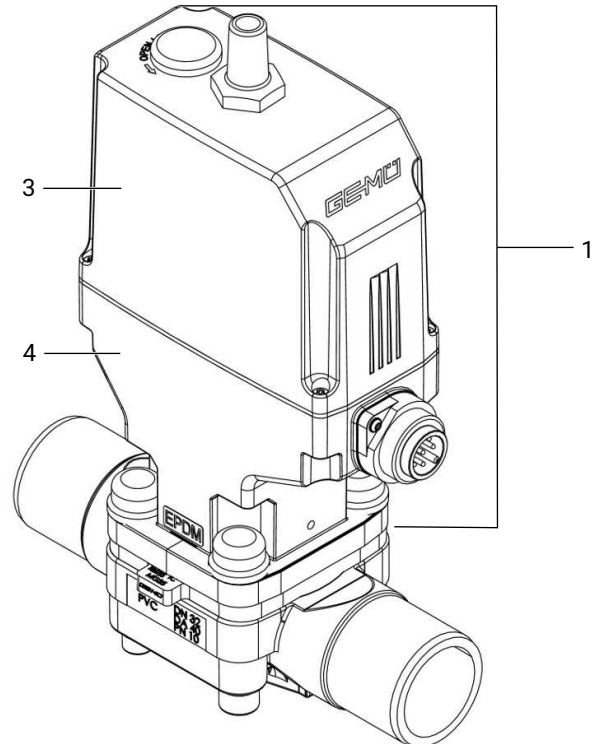
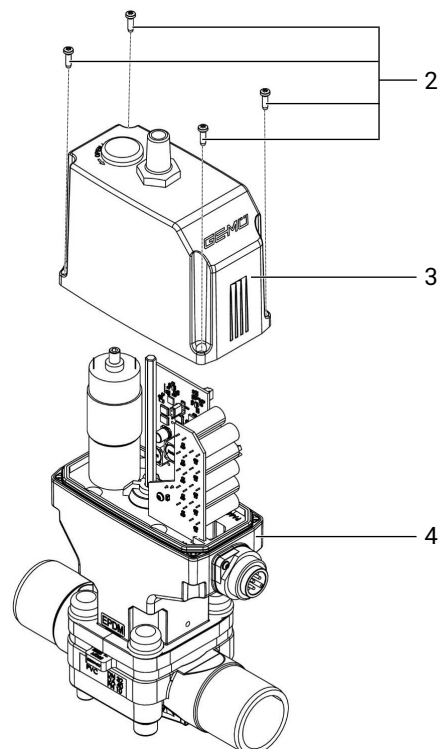

Fig. 1: Valve assembly with actuator 1 (cover 3 and base 4)



1. Detach screws 2 (Torx 10) from housing base 4.

⇒ Screws **2** can remain in cover **3**, and so do not get lost.

2. Detach and remove housing cover **3** by wiggling it.

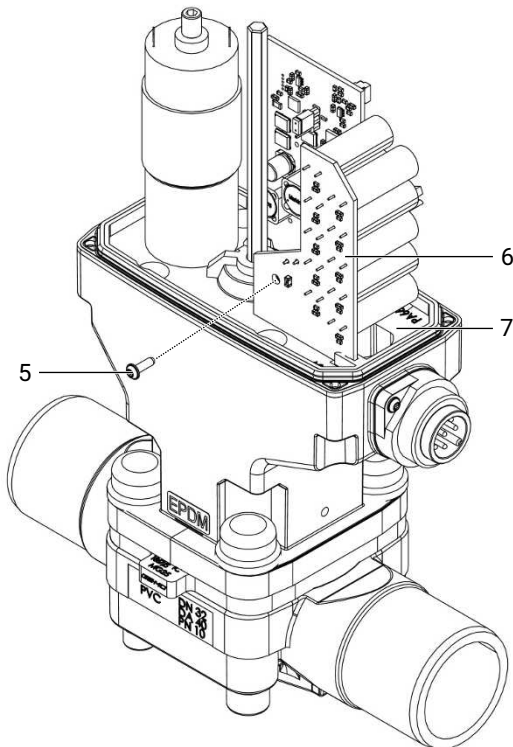

3. Remove screw **5** (Torx 8) and carefully detach emergency power supply module **6** from mounting plate **7**.
4. Unplug the emergency power supply module.

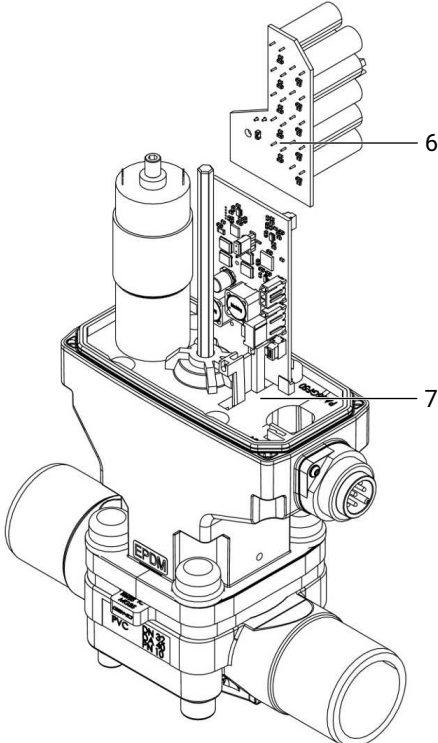

5. Reconnect and reassemble new emergency power supply module **6** in reverse order

4 Replacement of toothed gear

NOTICE



Electrostatic discharge!

- Destruction of electronic components.
- Take the necessary ESD safety precautions during installation of the product.

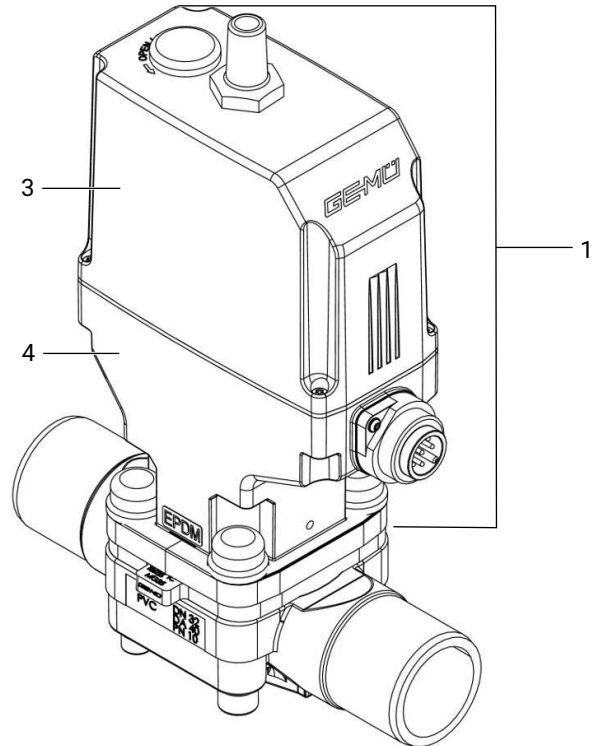
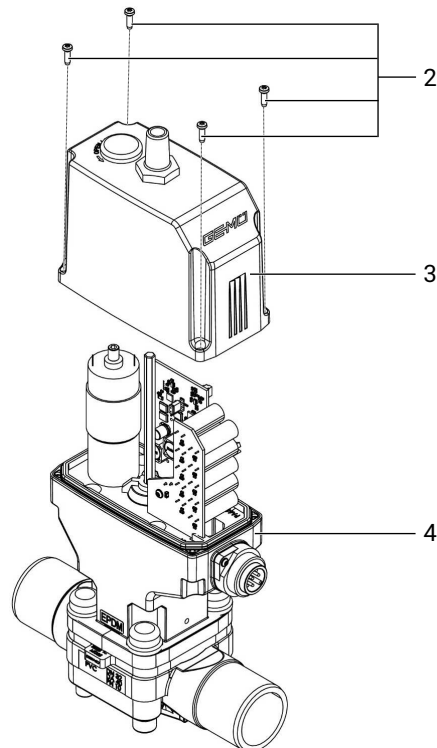

Fig. 2: Valve assembly with actuator **1** (cover **3** and base **4**)



1. Detach screws **2** (Torx 10) from housing base **4**.

⇒ Screws **2** can remain in cover **3**, and so do not get lost.

2. Detach and remove housing cover **3** by wiggling it.

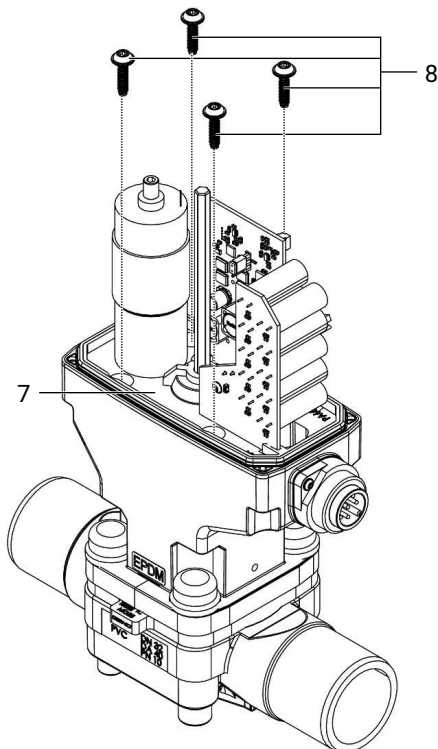

3. If an emergency power supply module is installed, this must be removed (see "Replacement of emergency power supply module", page 5).
4. Detach and remove screws **8** (Torx Plus 20, or Torx 20) from mounting plate **7**.

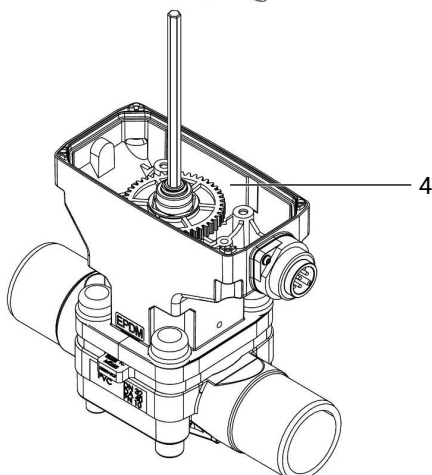
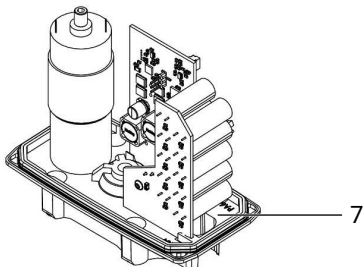

5. Remove mounting plate assembly **7** from base **4** by wiggling it.

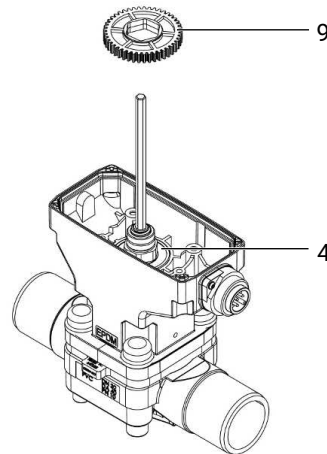

6. Use an appropriate tool to remove toothed gear **9** from housing base **4** and replace it.
7. Carry out assembly in reverse order.
 - ⇒ When doing so, try to hit the threads of the self-tapping screws again to minimize wear on the threaded connections.
8. Test the performance of the product.



GEMÜ Gebr. Müller Apparatebau GmbH & Co. KG
Fritz-Müller-Straße 6-8, 74653 Ingelfingen-Criesbach, Germany
Phone +49 (0) 7940 1230 · info@gemue.de
www.gemu-group.com

Subject to alteration

10.2024 | 88929393