

GEMÜ 423

Motorized butterfly valve

EN

Operating instructions



All rights including copyrights or industrial property rights are expressly reserved.

Keep the document for future reference.

© GEMÜ Gebr. Müller Apparatebau GmbH & Co. KG
27.03.2026

Contents

1	General information	4
1.1	Information	4
1.2	Symbols used	4
1.3	Definition of terms	4
1.4	Warning notes	4
2	Safety information	5
3	Intended use	6
4	Product description	7
4.1	Description	7
4.2	Product label	7
4.3	Configuration	7
4.4	Condition as supplied to customer	8
4.5	Optional accessories	8
5	Actuator range overviews	9
6	Order data	10
6.1	Butterfly valve with actuator GEMÜ 9428	10
6.2	Butterfly valve with actuator GEMÜ RP	12
6.3	Butterfly valve with actuator J+J	14
7	Butterfly valve technical data	16
8	Technical data of actuator	17
8.1	GEMÜ 9428 actuators	17
8.2	J+J actuators	18
8.3	Actuator RP	18
9	Dimensions	19
9.1	Actuator	19
9.2	Third-party actuators	20
9.3	Body	21
10	Manufacturer's information	22
10.1	Delivery	22
10.2	Transport	22
10.3	Storage	22
11	Installation in piping	22
11.1	Preparing for installation	22
11.2	Installation location	23
11.3	Mounting the product	23
12	Electrical connection	23
12.1	Connection/wiring diagram	25
13	Operation	33
14	Commissioning	35
15	Inspection and maintenance	35
15.1	Cleaning the product	36
15.2	Replace actuator	36
15.3	Replacing the shut-off seal	37
16	Troubleshooting	37
17	Disassembly	38
18	Disposal	38
19	Returns	38
20	Spare parts	38
20.1	Ordering spare parts	38
20.2	Spare parts overview	38
21	EU Declaration of Incorporation	40
22	EU Declaration of Conformity	41
23	EU Declaration of Conformity	42

1 General information

1.1 Information

- The descriptions and instructions apply to the standard versions. For special versions not described in this document the basic information contained herein applies in combination with any additional special documentation.
- Correct installation, operation, maintenance and repair work ensure faultless operation of the product.
- Should there be any doubts or misunderstandings, the German version is the authoritative document.
- Contact us at the address on the last page for staff training information.

1.2 Symbols used

The following symbols are used in this document:

Symbol	Meaning
●	Tasks to be performed
▶	Response(s) to tasks
–	Lists

1.3 Definition of terms

Working medium

The medium that flows through the GEMÜ product.

Control function

The possible actuation functions of the GEMÜ product.

Control medium

The medium whose increasing or decreasing pressure causes the GEMÜ product to be actuated and operated.

1.4 Warning notes

Wherever possible, warning notes are organized according to the following scheme:

SIGNAL WORD	
Possible symbol for the specific danger	Type and source of the danger ▶Possible consequences in case of non-compliance ●Measures for avoiding danger

Warning notes are always labelled with a signal word and sometimes also with a symbol for the specific danger.

The following signal words and danger levels are used:









⚠ DANGER	
	Imminent danger! ▶ Non-observance can cause death or severe injury



⚠ WARNING	
	Potentially dangerous situation! ▶ Non-observance can cause death or severe injury

⚠ CAUTION	
	Potentially dangerous situation! ▶ Non-observance can cause moderate to light injury

NOTICE	
	Potentially dangerous situation! ▶ Non-observance can cause damage to property

The following symbols for the specific dangers can be used within a warning note:

Symbol	Meaning
	Danger of explosion!
	Risk of crushing!
	Risk of electric shock!
	The equipment is subject to pressure!
	Corrosive chemicals!
	Hot plant components!
	Maximum permissible pressure exceeded!
	Damage to the butterfly valve
	Power supply!

Symbol	Meaning
	Electric shock by dangerous voltage!
	Leakage!
	Do not open the actuator!

2 Safety information

The safety information in this document refers only to an individual product. Potentially dangerous conditions can arise in combination with other plant components, which need to be considered on the basis of a risk analysis. The operator is responsible for the production of the risk analysis and for compliance with the resulting precautionary measures and regional safety regulations.

The document contains fundamental safety information that must be observed during commissioning, operation and maintenance. Non-compliance with these instructions may cause:

- Personal hazard due to electrical, mechanical and chemical effects
- Hazard to nearby equipment
- Failure of important functions
- Hazard to the environment due to the leakage of dangerous materials

The safety information does not take into account:

- Unexpected incidents and events, which may occur during installation, operation and maintenance
- Local safety regulations which must be adhered to by the operator and by any additional installation personnel

Prior to commissioning:

1. Transport and store the product correctly.
2. Do not paint the bolts and plastic parts of the product.
3. Carry out installation and commissioning using trained personnel.
4. Provide adequate training for installation and operating personnel.
5. Ensure that the contents of the document have been fully understood by the responsible personnel.
6. Define the areas of responsibility.
7. Observe the safety data sheets.
8. Observe the safety regulations for the media used.

During operation:

9. Keep this document available at the place of use.
10. Observe the safety information.
11. Operate the product in accordance with this document.
12. Operate the product in accordance with the specifications.
13. Maintain the product correctly.
14. Do not carry out any maintenance work and repairs not described in this document without consulting the manufacturer first.

In cases of uncertainty:

15. Consult the nearest GEMÜ sales office.

3 Intended use

DANGER



Danger of explosion!

- ▶ Risk of severe injury or death
- Do not use the product in potentially explosive zones.
- Only use the product in potentially explosive zones confirmed in the declaration of conformity.

WARNING

Improper use of the product!

- ▶ Risk of severe injury or death
- ▶ Manufacturer liability and guarantee will be void.
- Only use the product in accordance with the operating conditions specified in the contract documentation and in this document.

The product is designed for installation in piping systems and for controlling a working medium.

- Use the product in accordance with the technical data.

4 Product description

4.1 Description

The product is a butterfly valve. The product controls a flowing medium by being closed or opened by a motorized actuator. The product has a low-maintenance motorized actuator with a powerful reversible DC motor. The reduction gear, consisting of a threaded spindle with a lever, causes rotation through 90°. The actuator has an optical position indicator and a manual override as standard.

The product is available in different designs. It has two operating states – "closed" and "open".

4.2 Product label

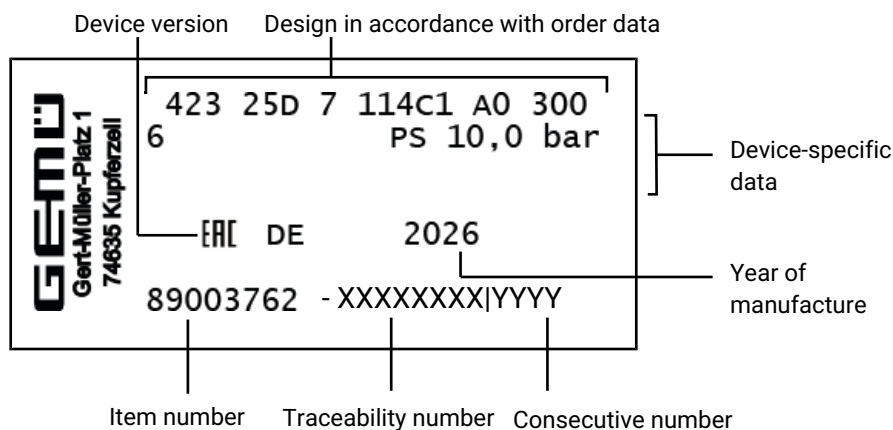

The month of manufacture is encoded in the traceability number and can be obtained from GEMÜ. The product was manufactured in Germany.

4.3 Configuration



Item	Name	Material
1	Butterfly valve body	PVC-U, grey
2	Pipe connections	PVC-U, grey
3	Housing base	Actuator versions 3006, 3015, 2015: PP + 30% glass fibre reinforced Actuator version 3035: PP + 20% glass bead reinforced
4	Connection for manual override	
5	Optical position indicator	PP-R natural
6	Housing cover	Actuator versions 3006, 3015, 2015: PPE + 30% glass fibre reinforced Actuator version 3035: PP + 20% glass bead reinforced

4.4 Condition as supplied to customer

The product is supplied as a separately packed component.

4.5 Optional accessories

- GEMÜ 1570 emergency power supply module
- GEMÜ 1225 electrical position indicator

5 Actuator range overviews

GEMÜ 9428 availability

Actuator version Code ¹⁾	Control module Code ²⁾	Voltage/Frequency			
		12 V DC (code B1)	12 V AC (code B4)	24 V DC (code C1)	24 V AC (code C4)
3006	A0, AE	X	X	X	X
3015	A0, AE	X	-	X	-
2015	A0, AE	-	X	-	X
3035	A0, AE	-	-	X	-

1) Actuator version

Code 3006: Actuator, motorized, operating time 4 s, torque 6 Nm, GEMÜ, size 3, supply voltage B1, C1, B4, C4

Code 3015: Actuator, motorized, operating time 11 s, torque 15 Nm, GEMÜ, size 3, supply voltage B1, C1

Code 2015: Actuator, motorized, operating time 11 s, torque 15 Nm, GEMÜ, size 2, supply voltage B4, C4

Code 3035: Actuator, motorized, operating time 15 s, torque 35 Nm, GEMÜ, size 3, supply voltage C1

2) Control module

Code A0: ON/OFF actuator

Code AE: ON/OFF actuator, two additional potential-free limit switches, Class A (EN15714-2)

RP – control module

Control module	Code ¹⁾	Actuator version (code)		
		RP32	RP64	RP100
ON/OFF	A0	X	X	X
	AE	X	X	X
Positioner	E1	X	X	X
	E2	X	X	X

1) Control module

Code A0: ON/OFF actuator

Code AE: ON/OFF actuator, two additional potential-free limit switches, Class A (EN15714-2)

Code E1: Control actuator, external set value 0–10 VDC

Code E2: Control actuator, external set value 0/4–20 mA

J4C actuators range overview

Actuator version Code ¹⁾	Control module Code ²⁾	DN					
		15	20	25	32	40	50
J4C20	AE, AE1, AE2, AP, E1, E2	X	X	X	X	-	-
J4C35	AE, AE1, AE2, AP, E1, E2	-	-	-	-	X	X

1) Actuator version

Code J4C20: Actuator, motorized, operating time 9 s, torque 20 Nm, J+J, type J4, heating, IP67

Code J4C35: Actuator, motorized, operating time 9 s, torque 35 Nm, J+J, type J4, heating, IP67

2) Control module

Code AE: Open/Close control with 2 additional, potential-free limit switches

Code AE1: Open/Close control with 2 additional, potential-free limit switches, with BSR accupack (NC)

Code AE2: Open/Close control with 2 additional, potential-free limit switches, with BSR accupack (NO)

Code AP: Open/Close control, with 5 kOhm potentiometer output

Code E1: Positioner DPS, 0 - 10 V

Code E2: Positioner DPS 4 - 20 mA

6 Order data

6.1 Butterfly valve with actuator GEMÜ 9428

The order data provide an overview of standard configurations.

Please check the availability before ordering. Other configurations available on request.

Order codes

1 Type	Code
Butterfly valve, motorized	423

2 DN	Code
DN 15	15
DN 20	20
DN 25	25
DN 32	32
DN 40	40
DN 50	50

3 Body configuration	Code
2/2-way body	D

4 Connection type	Code
Union end with insert (socket) – DIN	7
Union end with inch insert – BS (socket)	33

5 Body material	Code
PVC-U, grey	1

6 Shut-off seal material	Code
FKM	4
EPDM	14

7 Voltage/Frequency	Code
12 VDC	B1
12 V, 50/60 Hz	B4
24 VDC	C1
24 V, 50/60 Hz	C4

8 Control module	Code
ON/OFF actuator	A0
ON/OFF actuator, two additional potential-free limit switches, Class A (EN15714-2)	AE

9 Actuator version	Code
Actuator, motorized, operating time 4 s, torque 6 Nm, GEMÜ, size 3, supply voltage B1, C1, B4, C4	3006
Actuator, motorized, operating time 11 s, torque 15 Nm, GEMÜ, size 2, supply voltage B4, C4	2015
Actuator, motorized, operating time 11 s, torque 15 Nm, GEMÜ, size 3, supply voltage B1, C1	3015
Actuator, motorized, operating time 15 s, torque 35 Nm, GEMÜ, size 3, supply voltage C1	3035

10 Special specification	Code
Parallel operation of multiple actuators	6410
1 Hirschmann connector N6R	6598
2 Harting Han 7D connector	6722
Without	

Order example

Ordering option	Code	Description
1 Type	423	Butterfly valve, motorized
2 DN	25	DN 25
3 Body configuration	D	2/2-way body
4 Connection type	7	Union end with insert (socket) – DIN
5 Body material	1	PVC-U, grey
6 Shut-off seal material	14	EPDM
7 Voltage/Frequency	C1	24 VDC
8 Control module	A0	ON/OFF actuator
9 Actuator version	3006	Actuator, motorized, operating time 4 s, torque 6 Nm, GEMÜ, size 3, supply voltage B1, C1, B4, C4
10 Special specification		Without

6.2 Butterfly valve with actuator GEMÜ RP

The order data provide an overview of standard configurations.

Please check the availability before ordering. Other configurations available on request.

Products ordered with **bold marked ordering options** are so-called preferred series. Depending on the nominal size, these are available more quickly.

Order codes

1 Type	Code
Butterfly valve, motorized	423

2 DN	Code
DN 15	15
DN 20	20
DN 25	25
DN 32	32
DN 40	40
DN 50	50

3 Body configuration	Code
2/2-way body	D

4 Connection type	Code
Union end with insert (socket) – DIN	7
Union end with inch insert – BS (socket)	33

5 Shut-off seal material	Code
FKM	4
EPDM	14

6 Voltage/Frequency	Code
12 VDC	B1
12 V, 50/60 Hz	B4
24 VDC	C1
24 V, 50/60 Hz	C4

7 Control module	Code
ON/OFF actuator	A0
ON/OFF actuator, two additional potential-free limit switches, Class A (EN15714-2)	AE

8 Actuator version	Code
Actuator, motorized, operating time 4 s, torque 6 Nm, GEMÜ, size 3, supply voltage B1, C1, B4, C4	3006
Actuator, motorized, operating time 11 s, torque 15 Nm, GEMÜ, size 3, supply voltage B1, C1	3015
Actuator, motorized, operating time 15 s, torque 35 Nm, GEMÜ, size 3 supply voltage C1	3035

9 Type of design	Code
Standard	
Parallel operation of multiple actuators	6410
1 Hirschmann connector N6R	6598
2 Harting Han 7D connector	6722

Order example

Ordering option	Code	Description
1 Type	423	Butterfly valve, motorized
2 DN	25	DN 25
3 Body configuration	D	2/2-way body
4 Connection type	7	Union end with insert (socket) – DIN
5 Body material	1	PVC-U, grey
6 Shut-off seal material	14	EPDM
7 Voltage/Frequency	C1	24 VDC
8 Control module	A0	ON/OFF actuator
9 Actuator version	3006	Actuator, motorized, operating time 4 s, torque 6 Nm, GEMÜ, size 3, supply voltage B1, C1, B4, C4
10 Special specification		Without

6.3 Butterfly valve with actuator J+J

The order data provide an overview of standard configurations.

Please check the availability before ordering. Other configurations available on request.

Order codes

1 Type	Code
Butterfly valve, motorized	423
2 DN	Code
DN 15	15
DN 20	20
DN 25	25
DN 32	32
DN 40	40
DN 50	50
3 Body configuration	Code
2/2-way body	D
4 Connection type	Code
Union end with insert (socket) – DIN	7
Union end with inch insert – BS (socket)	33
5 Body material	Code
PVC-U, grey	1
6 Shut-off seal material	Code
FKM	4
EPDM	14
7 Voltage/Frequency	Code
12 VDC	B1
24 V–240 V AC/DC for model 20, 35, 55, 85, 140, 300	U5
8 Control module	Code
ON/OFF actuator, two additional potential-free limit switches, Class A (EN15714-2)	AE
ON/OFF actuator, two additional potential-free limit switches, BSR battery pack (NC)	AE1
ON/OFF actuator, two additional potential-free limit switches, BSR battery pack (NO)	AE2
ON/OFF actuator, potentiometer output, Class A (EN15714-2)	AP
Control actuator, external set value 0–10 VDC	E1
Control actuator, external set value 0/4–20 mA	E2
9 Actuator version	Code
Actuator, motorized, operating time 9 s, torque 20 Nm, J+J, type J4, heating, IP67	J4C20
Actuator, motorized, operating time 9 s, torque 35 Nm, J+J, type J4, heating, IP67	J4C35

10 Special specification	Code
Without	
Media-wetted area cleaned to ensure suitability for paint applications, parts sealed in plastic bag	0101
Media-wetted parts cleaned for high purity media and packed in plastic bag	0104
Short insert, PE material, PN 10, (for butt welding)	1094
Insert made of PP, for butt welding	1146
K-no. 1060, K-no. 0101, 1060 – insert made of PP, 0101 – media-wetted area cleaned to ensure suitability for paint applications Parts sealed in plastic bag	1174

Order example

Ordering option	Code	Description
1 Type	423	Butterfly valve, motorized
2 DN	25	DN 25
3 Body configuration	D	2/2-way body
4 Connection type	7	Union end with insert (socket) – DIN
5 Body material	1	PVC-U, grey
6 Shut-off seal material	14	EPDM
7 Voltage/Frequency	U5	24 V–240 V AC/DC for model 20, 35, 55, 85, 140, 300
8 Control module	AE	ON/OFF actuator, two additional potential-free limit switches, Class A (EN15714-2)
9 Actuator version	J4C20	Actuator, motorized, operating time 9 s, torque 20 Nm, J+J, type J4, heating, IP67
10 Special specification		Without

7 Butterfly valve technical data

7.1 Medium

Working medium: Corrosive, inert, gaseous and liquid media which have no negative impact on the physical and chemical properties of the body, disc and seal material. The product is only suitable for use with fluids of group 2 according to the Pressure Equipment Directive.

7.2 Temperature

Media temperature: 0 – 60 °C

Ambient temperature: -10 – 60 °C

Storage temperature: 0 – 40 °C

7.3 Pressure

Operating pressure: 0 – 6 bar

Kv values:

DN	Kv value
15	7.0
20	13.0
25	17.0
32	33.0
40	53.0
50	74.0

Kv values in m³/h

Pressure/temperature correlation:

Material	Code	Temperature	Permissible operating pressure
PVC-U	1	10	10.0
		20	10.0
		25	10.0
		30	8.0
		40	6.0
		50	3.5
		60	1.5

Temperatures in °C

Pressures in bar

All pressures are gauge pressures.

The permissible operating pressure depends on the working medium temperature.

7.4 Product compliance

Machinery Directive: 2006/42/EC

EMC Directive: 2014/30/EU

Low Voltage Directive: 2014/35/EU

RoHS Directive: 2011/65/EU

7.5 Mechanical data

Torques:

DN	Torques
15	6.0
20	6.0
25	6.0
32	8.0
40	20.0
50	21.0

Torques in Nm

Weight:

DN	Weights
15	0.360
20	0.390
25	0.400
32	0.700
40	1.072
50	1.200

Weights in kg

8 Technical data of actuator

8.1 GEMÜ 9428 actuators

8.1.1 Mechanical data

Weight:

GEMÜ 9428

Supply voltage 12 V / 24 V:	1.0 kg
Actuator version 3035:	2.4 kg

Protection class:	IP 65 acc. to EN 60529
Nominal travel:	90°
Max. travel:	93°
Setting range:	0 to 20° (limit switch Min.) 70 to 93° (limit switch Max.)

8.1.2 Electrical data

Duty cycle:	Continuous duty
Electrical protection:	Motor protective system by customer
Electrical protection class:	I (DIN EN 61140)

8.1.2.1 Electrical connection

Electrical connection type:	Cable connection PG 13.5 Binder RD24 flange plug series 693, number of poles: 6+PE, IP67 (GEMÜ 3006, 3015)
Cable diameter:	7.5 – 12.5 mm
Max. cross section of wire:	1.5 mm ²

Recommended motor protection:

Voltage	12 V DC	24 V DC
Motor protection switch type	Siemens 3RV 1011-1CA10	Siemens 3RV 1011-1BA10
Set current	2.20	1.70

Current data in A

Rated voltage:12 V / 24 V AC or DC ($\pm 10\%$)**Rated frequency:**

50/60 Hz (at AC rated voltage)

Power consumption:

Actuator version	12 V DC	12 V AC	24 V DC	24 V AC
	Code B1	Code B4	Code C1	Code C4
3006	30.0	30.0	30.0	30.0
3015	30.0	-	30.0	-
2015	-	30.0	-	30.0
3035	-	-	30.0	-

Power consumption in W

Current consumption:

Actuator version	12 V DC	12 V AC	24 V DC	24 V AC
	Code B1	Code B4	Code C1	Code C4
3006	2.2	2.0	1.20	1.5
3015	2.2	-	1.20	-
2015	-	2.0	-	1.2
3035	-	-	1.30	-

Current data in A

Max. current at start up:

Actuator version	12 V DC	12 V AC	24 V DC	24 V AC
	Code B1	Code B4	Code C1	Code C4
3006	6.3	2.4	4.0	1.8
3015	9.2	-	3.8	-
2015	-	2.3	-	1.8
3035	-	-	3.3	-

Current data in A

8.2 J+J actuators

Note: For technical data see manufacturer's original datasheets

8.3 Actuator RP

See operating instructions for actuator AUMA RP.

9 Dimensions

9.1 Actuator

9.1.1 Actuator flange F05/G05

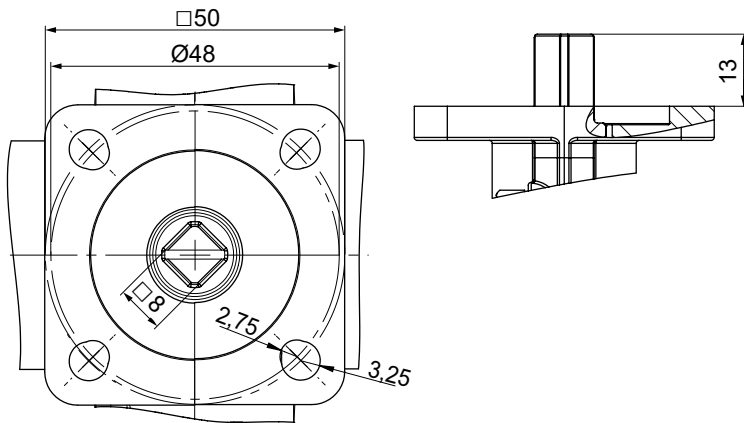

Dimensions in mm

9.1.2 Actuator version 2015

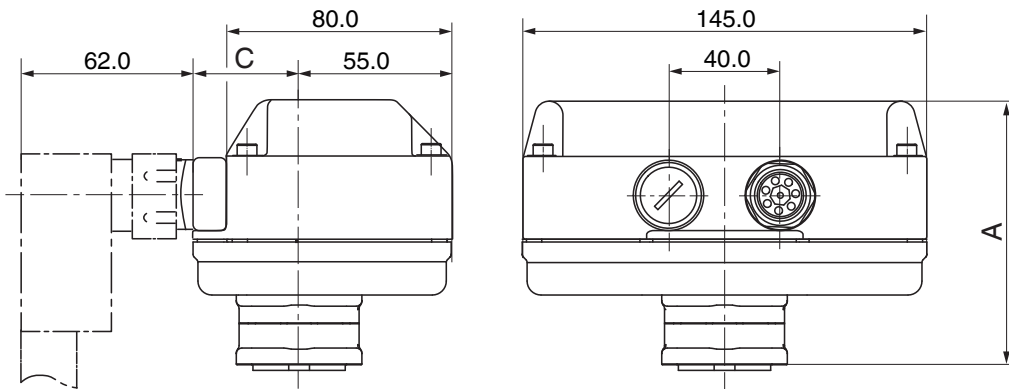

Actuator version	A	C
2015	122.0	53.0

Dimensions in mm

9.1.3 Actuator version 3006, 3015

ON/OFF actuator (control module code A0)

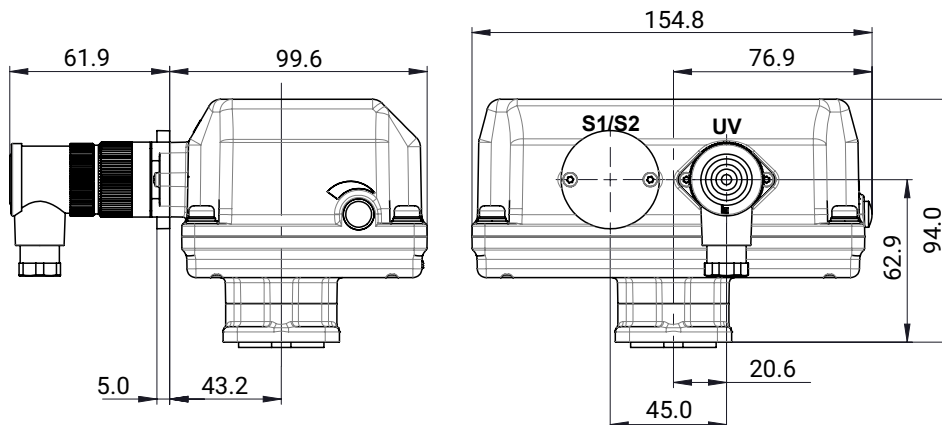

ON/OFF actuator (control module code A0/K-no. 7158)

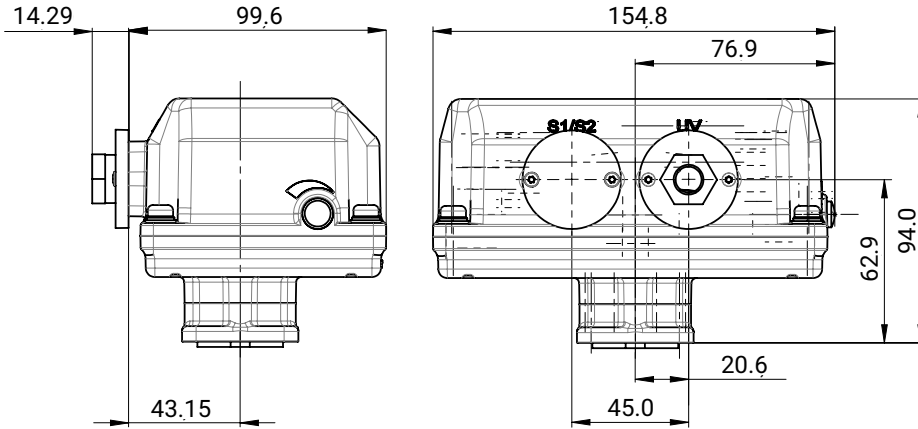

OPEN/CLOSE control, two additional potential-free limit switches (control module code AE)

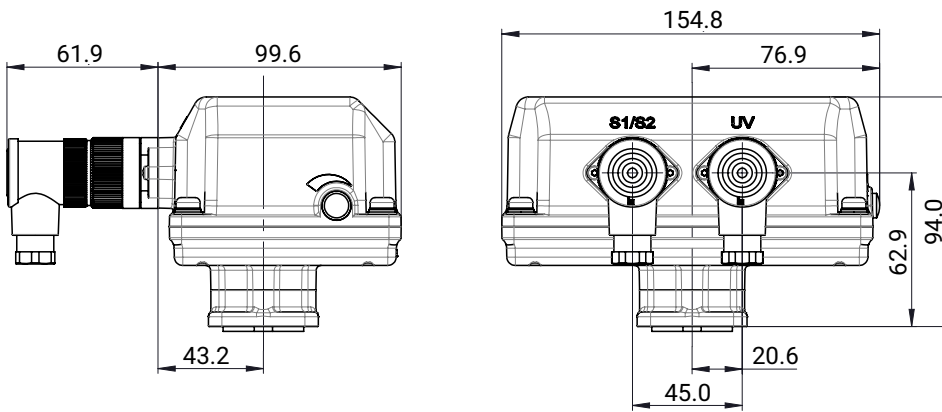

Dimensions in mm

9.1.4 Actuator version 3035

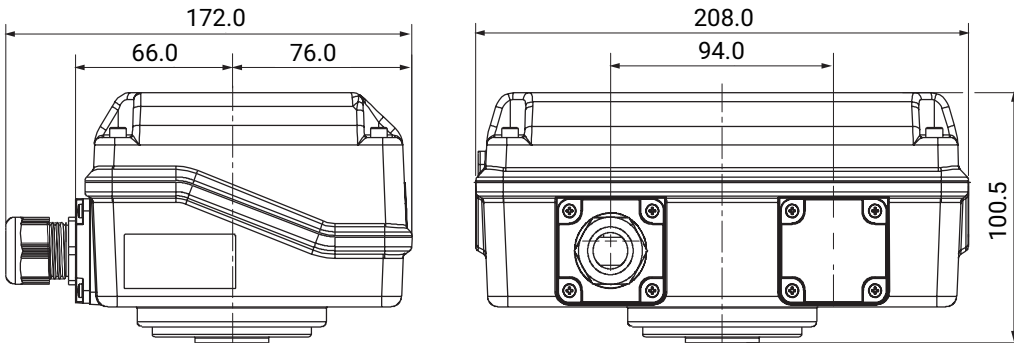

Dimensions in mm

9.2 Third-party actuators

For more detailed information on third-party actuators, refer to the manufacturers' documentation

9.3 Body

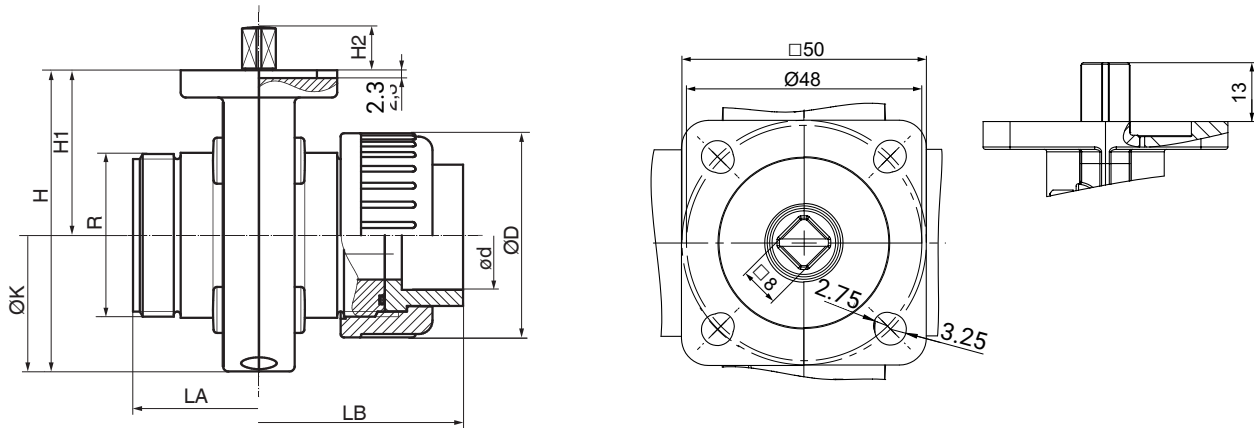

DN	LA	LB	H	H1	H2	ϕD	ϕd	R	ϕK
15	74.0	114.0	89.0	48.5	13.0	60.0	20.0	G 1 1/2	80.0
20	74.0	118.0	89.0	48.5	13.0	60.0	25.0	G 1 1/2	80.0
25	74.0	124.0	89.0	48.5	13.0	60.0	32.0	G 1 1/2	80.0
32	80.0	138.0	106.0	57.5	13.0	74.0	40.0	G 2	96.0
40	94.0	162.0	112.0	58.0	13.0	83.0	50.0	G 2 1/4	108.0
50	106.0	188.0	137.0	74.0	13.0	103.0	63.0	G 2 3/4	126.0

Dimensions in mm

10 Manufacturer's information

10.1 Delivery

- Check that all parts are present and check for any damage immediately upon receipt.

The product's performance is tested at the factory. The scope of delivery is apparent from the dispatch documents and the design from the order number.

10.2 Transport



1. Only transport the product by suitable means. Do not drop. Handle carefully.
2. After the installation dispose of transport packaging material according to relevant local or national disposal regulations / environmental protection laws.



10.3 Storage



1. Store the product free from dust and moisture in its original packaging.
2. Avoid UV rays and direct sunlight.
3. Do not exceed the maximum storage temperature (see chapter "Technical data").
4. Do not store solvents, chemicals, acids, fuels or similar fluids in the same room as GEMÜ products and their spare parts.
5. Close the compressed air connections with protection caps or sealing plugs.
6. Store the product in the "open" position.



11 Installation in piping



11.1 Preparing for installation



 DANGER	
	<p>Risk of crushing!</p> <ul style="list-style-type: none"> ▶ Risk of severe injury. ● Depressurize the plant before performing any work on the product. ● Observe correct handling procedures.

 DANGER	
	<p>Risk of electric shock!</p> <ul style="list-style-type: none"> ▶ Risk of injury or death (if operating voltage is higher than safe extra low voltage). ▶ Adjustments are made with the actuator cover removed. ▶ Electric shock can cause severe burns and fatal injury. ● Always disconnect the product from power supply! ● Therefore, have all work performed only by qualified electricians.



 WARNING	
	<p>The equipment is subject to pressure!</p> <ul style="list-style-type: none"> ▶ Risk of severe injury or death ● Depressurize the plant or plant component. ● Completely drain the plant or plant component.

 WARNING	
	<p>Corrosive chemicals!</p> <ul style="list-style-type: none"> ▶ Risk of caustic burns ● Wear appropriate protective gear. ● Completely drain the plant.

 CAUTION	
	<p>Hot plant components!</p> <ul style="list-style-type: none"> ▶ Burns ● Only work on plant that has cooled down. ● Wear protective gear.

 CAUTION	
	<p>Risk of crushing!</p> <ul style="list-style-type: none"> ▶ There is a risk of crushing when reaching into the valve. ● Installation and removal of the valve may only be performed by suitable/trained personnel. ● Install only if the valve is deenergized (without control energy). ● When used as an end-of-line valve, a mating flange must be used. ● The operator must ensure that the valve is adequately secured by piping, e.g. pipe bends or grids.

 CAUTION	
Use as step!	
<ul style="list-style-type: none"> ▶ Damage to the product ▶ Risk of slipping-off ● Choose the installation location so that the product cannot be used as a foothold. ● Do not use the product as a step or a foothold. 	

 CAUTION	
	<p>Maximum permissible pressure exceeded!</p> <ul style="list-style-type: none"> ▶ Damage to the product! ● Provide for precautionary measures against exceeding the maximum permissible pressure that may be caused by pressure surges (water hammer).

NOTICE**Suitability of the product!**

- ▶ The product must be appropriate for the piping system operating conditions (medium, medium concentration, temperature and pressure) and the prevailing ambient conditions.

NOTICE**Protective gear!**

- Wear appropriate protective gear in accordance with the plant operator's guidelines.

NOTICE**Tools!**

- ▶ The tools required for installation and assembly are not included in the scope of delivery.
- Use appropriate, functional and safe tools.

11.2 Installation location

1. Do not apply external force to the product
2. Choose the installation location so that the product cannot be used as a foothold.
3. Lay the piping so that the valve body is protected against thrust and bending forces, vibrations and tension.
4. Only install the product between matching aligned pipes.

Installation position

- Align the product preferably with the actuator facing upwards.
- Any direction of working medium is OK.

11.3 Mounting the product

1. Shut off the plant or plant component.
2. Secure against recommissioning.
3. Depressurize the plant or plant component.
4. Completely drain the plant or plant component and allow it to cool down until the temperature is below the media vaporization temperature and cannot cause scalding.
5. Correctly decontaminate, rinse and ventilate the plant or plant component.

Installation – Union ends with insert**CAUTION****Damage to the butterfly valve**

- Only use adhesive suitable for the valve body.

NOTICE

- ▶ The solvent cement is not included in the scope of delivery.
- Only use suitable solvent cement!

NOTICE

- ▶ Observe the appropriate regulations for the connections.

6. Unscrew the union nut **1** on the valve body **2**.

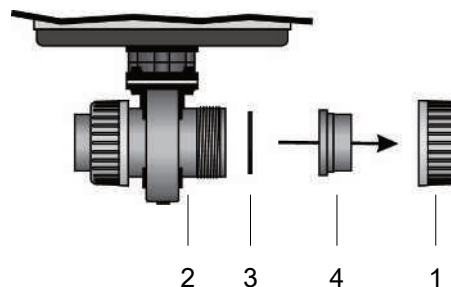

7. Reinsert the O-ring **3** if necessary.
8. Place the insert **4** into the union nut **1**.
9. Glue the union nut **1** with insert **4** onto the pipe **5**.

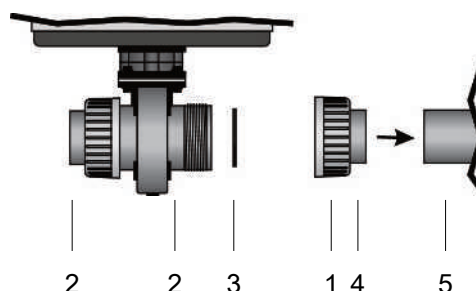

10. Reinsert the O-ring **3** if necessary.
11. Screw the union nut **1** back onto the valve body **2**.
12. Connect the valve body **2** to piping **5** on the other side in a like manner.

After the installation

13. Re-attach or reactivate all safety and protective devices.

12 Electrical connection**DANGER****Risk of electric shock!**

- ▶ Risk of injury or death (if operating voltage is higher than safe extra low voltage).
- ▶ Adjustments are made with the actuator cover removed.
- ▶ Electric shock can cause severe burns and fatal injury.
- **Always** disconnect the product from power supply!
- Therefore, have all work performed only by qualified electricians.

⚠ CAUTION**Power supply!**

- Power supply varies dependent on the design (see product label).
- Do not bridge terminals!
- For parallel connection of several actuators, use the version with K-no. 6410.
- With version AE (additional potential-free limit switches), the plug connections must not be interchanged with the power supply.

NOTICE**Required for electrical connection:**

- Allen key size SW3
- Small flat screw driver

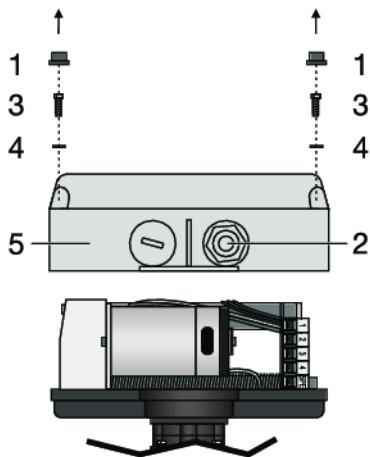

1. Disconnect the plant from power supply.
2. Remove the protective caps **1**.
3. Unscrew cable entry **2**.
4. Undo screws **3**.
5. Do not lose the washers **4**.
6. Remove the cover of the actuator **5**.
7. Insert cable through cable entry **2**.
Remove internal sealing ring if necessary.
8. Connect cable (see chapter "Connection diagram 12 / 24 V" and chapter "Connection diagram 100 - 250 V").
9. Put on cover of actuator **5**.
10. Tighten cover **5**.
11. Put on protective caps **1**.
12. Screw down cable entry **2**.

12.1 Connection/wiring diagram

12.1.1 ON/OFF actuator (code A0)

12 V AC (code B4) / 24 V AC (code C4)

Assignment of the terminal strips

Actuator version
2015, and 3006
with K-no. 7158

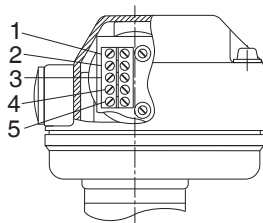

Item	Description
1	L1, supply voltage
2	N, supply voltage
3	L1, change-over (OPEN/CLOSED)
4	N, change-over (OPEN/CLOSED)
5	PE, protective earth conductor

Preferred direction -OPEN- when all signals are present

Connection diagram

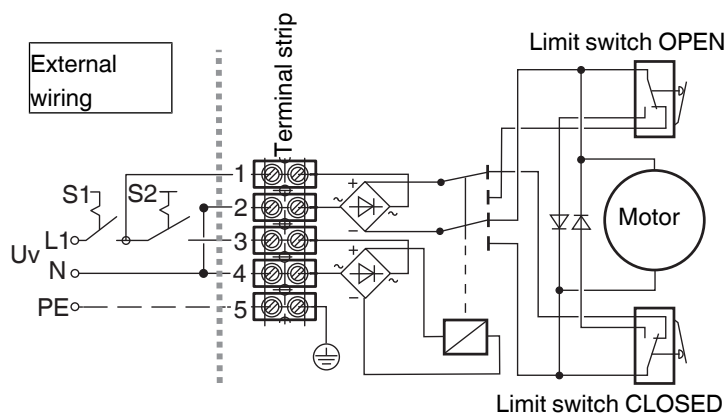

S1	Actuator
0	OFF
1	ON

S2	Direction of travel
0	CLOSED
1	OPEN

12 V DC (code B1) / 24 V DC (code C1)

Position of the connectors

Actuator version
3006, 3015

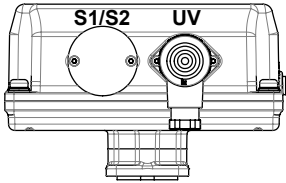

Electrical connection

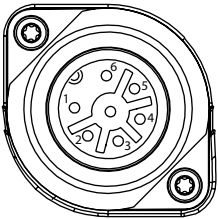

Plug assignment UV

Pin	Description
1	Uv+, direction of travel CLOSED
2	Uv-, direction of travel CLOSED
3	Uv+, direction of travel OPEN
4	Uv-, direction of travel OPEN
5	n.c.
6	n.c.
	PE, protective earth conductor

Connection diagram

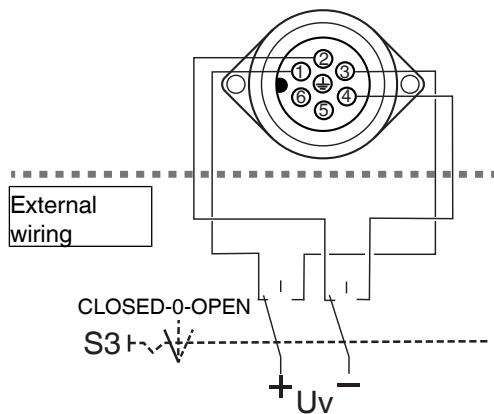

Connection assignment X1, UV

S3	Actuator
CLOSED	Direction of travel CLOSED
0	OFF
OPEN	Direction of travel OPEN

12 V AC (code B4) / 24 V AC (code C4) / K-no. 6598**Position of the connectors**

Actuator version:
2015

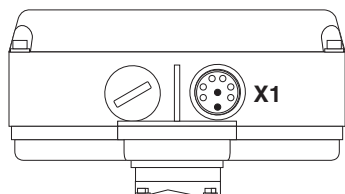
**Electrical connection**

Plug assignment X1

Pin	Description
1	L1, supply voltage
2	N, supply voltage
3	L1, change-over (OPEN/CLOSED)
4	N, change-over (OPEN/CLOSED)
5	n.c.
6	n.c.
	PE, protective earth conductor

Preferred direction -OPEN- when all signals are present

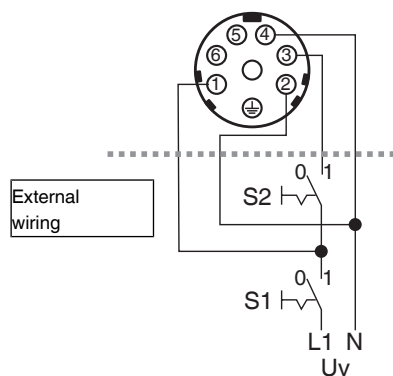
Connection diagram

S1	Actuator
0	OFF
1	ON

S2	Direction of travel
0	CLOSED
1	OPEN

12 V DC (code B1) / 24 V DC (code C1)

Assignment of the terminal strips

Actuator version
 3006, 3015 with K-no. 7158, and
 3035, 3055

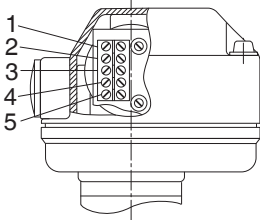

Item	Description
1	Uv+, direction of travel CLOSED
2	Uv-, direction of travel CLOSED
3	Uv+, direction of travel OPEN
4	Uv-, direction of travel OPEN
5	PE, protective earth conductor

Connection diagram

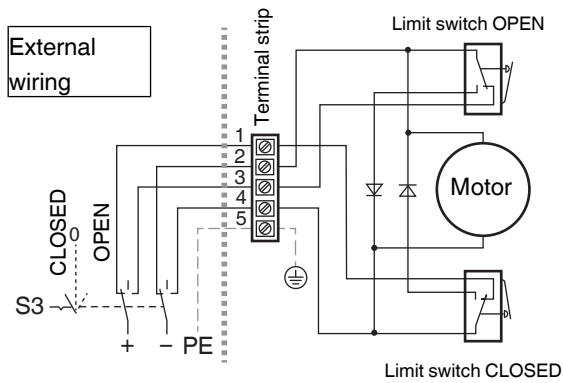

S3	Actuator
CLOSED	Direction of travel CLOSED
0	OFF
OPEN	Direction of travel OPEN

12.1.2 ON/OFF actuator with 2 potential-free limit switches (code AE)

12 V DC (code B1) / 24 V DC (code C1)

Position of the connectors

Actuator version
3006, 3015

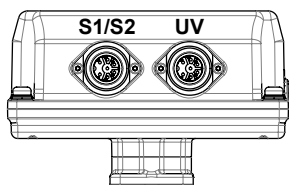

Electrical connection

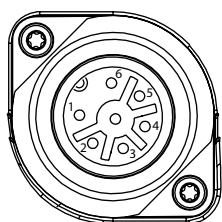

Plug assignment UV

Pin	Description
1	Uv+, direction of travel CLOSED
2	Uv-, direction of travel CLOSED
3	Uv+, direction of travel OPEN
4	Uv-, direction of travel OPEN
5	n.c.
6	n.c.
	PE, protective earth conductor

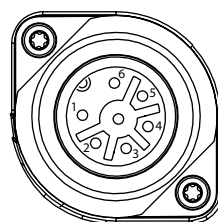

Plug assignment S1/S2

Pin	Description
1	Change-over contact limit switch CLOSED
2	Make contact limit switch CLOSED
3	Break contact limit switch CLOSED
4	Break contact limit switch OPEN
5	Make contact limit switch OPEN
6	Change-over contact limit switch OPEN
	PE, protective earth conductor

Connection diagram

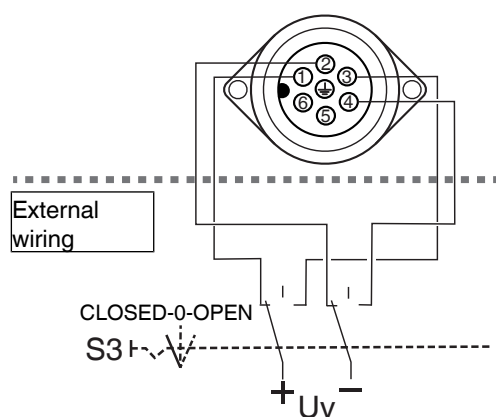

Connection assignment UV

S3	Actuator
CLOSED	Direction of travel CLOSED
0	OFF
OPEN	Direction of travel OPEN

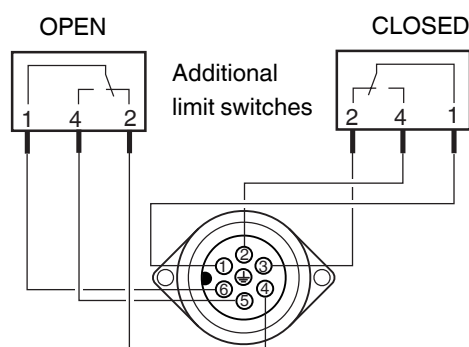

12 V DC (code B1) / 24 V DC (code C1)

Position of the connectors

Actuator version
3035, 3055

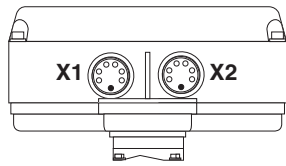

Electrical connection



Plug assignment X1

Pin	Description
1	Uv+, direction of travel CLOSED
2	Uv-, direction of travel CLOSED
3	Uv+, direction of travel OPEN
4	Uv-, direction of travel OPEN
5	n.c.
6	n.c.
	PE, protective earth conductor



Plug assignment X2

Pin	Description
1	Change-over contact limit switch CLOSED
2	Make contact limit switch CLOSED
3	Break contact limit switch CLOSED
4	Break contact limit switch OPEN
5	Make contact limit switch OPEN
6	Change-over contact limit switch OPEN
	PE, protective earth conductor

Connection diagram

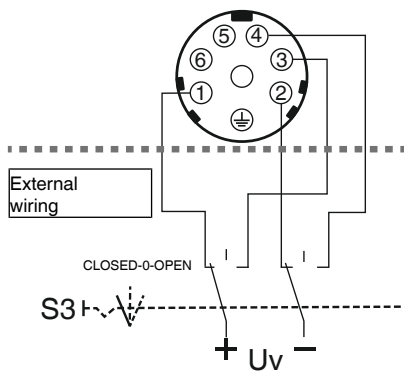

Connection assignment X1, UV

S3	Actuator
CLOSED	Direction of travel CLOSED
0	OFF
OPEN	Direction of travel OPEN

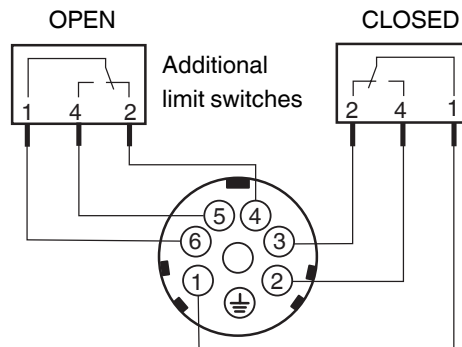

12 V AC (code B4) / 24 V AC (code C4)

Position of the connectors

Actuator version 2015

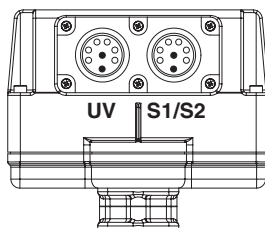

Electrical connection



Plug assignment UV

Pin	Description
1	L1, supply voltage
2	N, supply voltage
3	L1, change-over (OPEN/CLOSED)
4	N, change-over (OPEN/CLOSED)
5	n.c.
6	n.c.
⊕	PE, protective earth conductor



Plug assignment S1/S2

Pin	Description
1	Change-over contact limit switch CLOSED
2	Make contact limit switch CLOSED
3	Break contact limit switch CLOSED
4	Break contact limit switch OPEN
5	Make contact limit switch OPEN
6	Change-over contact limit switch OPEN
⊕	PE, protective earth conductor

Preferred direction -OPEN- when all signals are present

Connection diagram

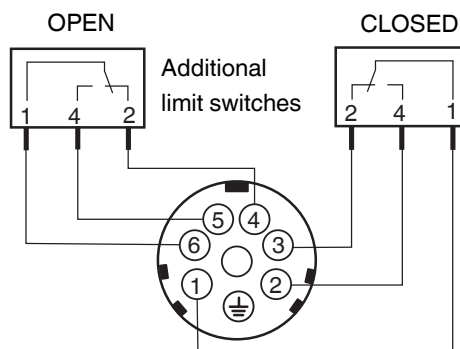
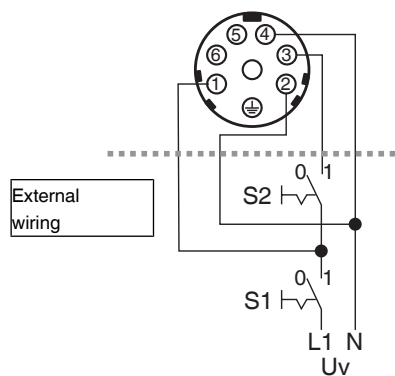

Connection diagram X1, UV

S1	Actuator
0	OFF
1	ON

S2	Direction of travel
0	CLOSED
1	OPEN

12 V AC (code B4) / 24 V AC (code C4) / K-no. 6722

Position of the connectors

Actuator version:
2015

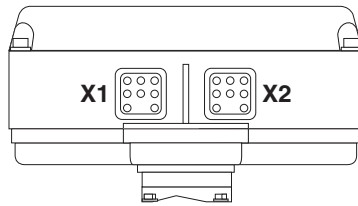

Electrical connection



Plug assignment X1

Pin	Description
1	L1, supply voltage
2	N, supply voltage
3	L1, change-over (OPEN/CLOSED)
4	N, change-over (OPEN/CLOSED)
5	n.c.
6	n.c.
7	n.c.
⊕	PE, protective earth conductor



Plug assignment X2

Pin	Description
1	Change-over contact limit switch CLOSED
2	Make contact limit switch CLOSED
3	Break contact limit switch CLOSED
4	Break contact limit switch OPEN
5	Make contact limit switch OPEN
6	Change-over contact limit switch OPEN
7	n.c.
⊕	PE, protective earth conductor

Preferred direction -OPEN- when all signals are present

Connection diagram

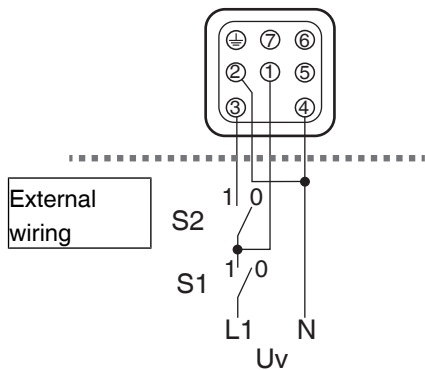

Connection diagram X1

S1	Actuator
0	OFF
1	ON

S2	Direction of travel
0	CLOSED
1	OPEN

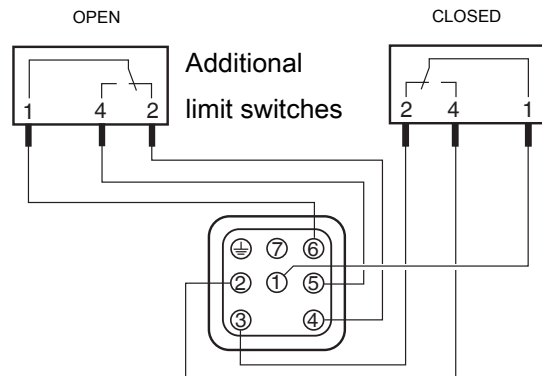

13 Operation

13.1 Optical position indicator

The actuator has an optical position indicator which indicates the position of the actuator.

Actuator versions 2006, 2015, 3035

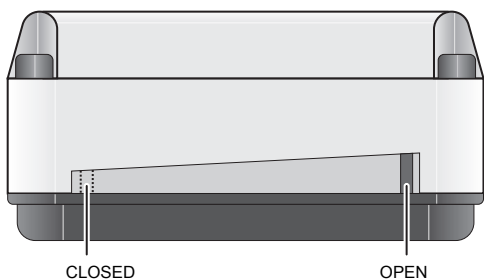

13.2 Manual override

⚠ DANGER	
	<p>Electric shock by dangerous voltage!</p> <ul style="list-style-type: none"> ▶ Risk of injury or death (if operating voltage is higher than safe extra low voltage). ● Switch off power to the actuator before using the manual override.

⚠ CAUTION	
<p>Only actuate the manual override when the power is switched off!</p> <ul style="list-style-type: none"> ▶ Damage to the actuator! 	

⚠ CAUTION	
<p>Set the actuator position to "centred" after using the manual override!</p> <ul style="list-style-type: none"> ▶ Trip cams may be outside the limit switches as the limit switch position was manually exceeded by the manual override. ▶ Damage to the actuator. ● Set the actuator position to "centred" before electrical operation. 	

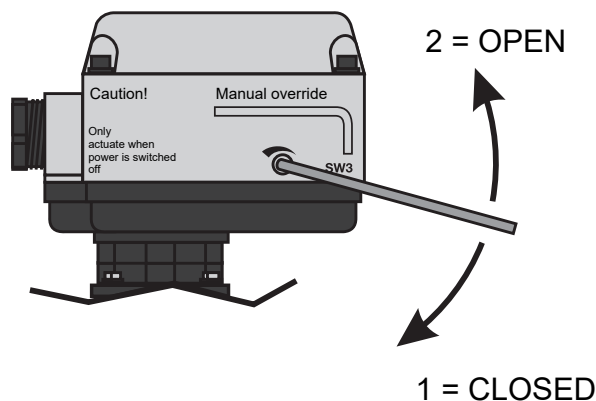

Actuator versions
2006, 2015

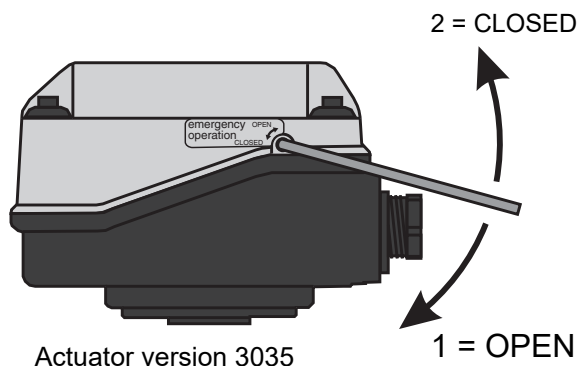

Actuator version 3035

13.3 Setting the limit switches

⚠ DANGER



Risk of electric shock!

- ▶ Risk of injury or death (if operating voltage is higher than safe extra low voltage).
- ▶ Adjustments are made with the actuator cover removed.
- ▶ Electric shock can cause severe burns and fatal injury.
- **Always** disconnect the product from power supply!
- Therefore, have all work performed only by qualified electricians.

⚠ CAUTION

Destruction of the actuator!

- ▶ Do not move the right limit switch too far to the right and the left limit switch too far to the left, otherwise the actuator will continue running in the end position (i.e. the limit switch cannot be actuated by the lever and the actuator continues to run).

NOTICE

Tools required for setting the limit switches:

- Allen key SW3
- Small Philips head screw driver

NOTICE

- Always switch the limit switch for signal so that the motor switch is actuated first.

⇒ Limit switches for signal and motor are already preset.

The GEMÜ 9428 motorized actuator is delivered in open position.

The following drawings differ depending on the actuator version!

1. Disconnect the plant from power supply and secure against recommissioning.

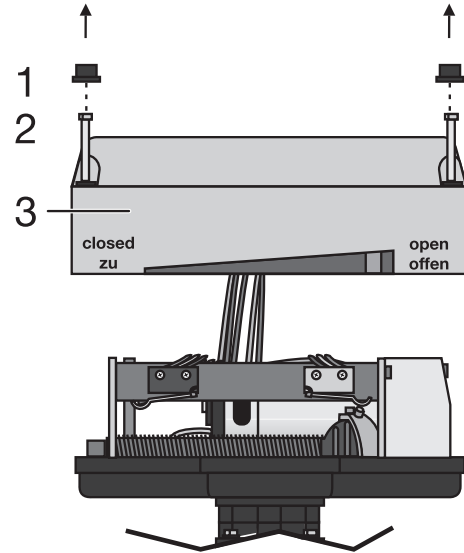

2. Remove the protective caps 1.
3. Undo screws 2.
4. Disassemble the cover of the actuator 3.

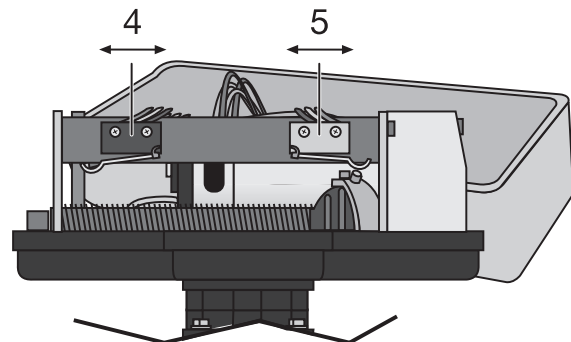

5. Undo screws at the respective limit switch (4 = "CLOSED", 5 = "OPEN").
6. Move limit switches to the desired position.
7. Tighten limit switch screws.

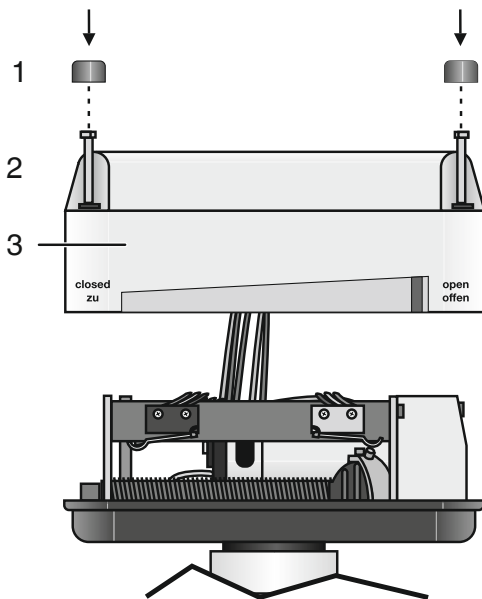

8. Put on cover of actuator 3.
 9. Tighten cover 3.
 10. Put on protective caps 1.
- ⇒ Limit switches are set.

14 Commissioning

⚠ WARNING



Corrosive chemicals!

- ▶ Risk of caustic burns
- Wear appropriate protective gear.
- Completely drain the plant.

⚠ CAUTION



Leakage!

- ▶ Emission of dangerous materials
- Provide for precautionary measures against exceeding the maximum permissible pressure that may be caused by pressure surges (water hammer).

⚠ CAUTION

Cleaning agent!

- ▶ Damage to the GEMÜ product
- The plant operator is responsible for selecting the cleaning material and performing the procedure.

1. Check the tightness and the function of the product (close and reopen the product).
 2. Flush the piping system of new plant and following repair work (the product must be fully open).
- ⇒ Harmful foreign matter has been removed.
- ⇒ The product is ready for use.
3. Commission the product.
 4. Commissioning of actuators in accordance with the enclosed instructions.

15 Inspection and maintenance

⚠ WARNING



The equipment is subject to pressure!

- ▶ Risk of severe injury or death
- Depressurize the plant or plant component.
- Completely drain the plant or plant component.

⚠ CAUTION



Hot plant components!

- ▶ Burns
- Only work on plant that has cooled down.
- Wear protective gear.

⚠ CAUTION



Risk of crushing!

- ▶ There is a risk of crushing when reaching into the valve.
- Installation and removal of the valve may only be performed by suitable/trained personnel.
- Install only if the valve is deenergized (without control energy).
- When used as an end-of-line valve, a mating flange must be used.
- The operator must ensure that the valve is adequately secured by piping, e.g. pipe bends or grids.

NOTICE

Use of incorrect spare parts!

- ▶ Damage to the GEMÜ product
- ▶ The manufacturer liability and guarantee will be void.
- Use only genuine parts from GEMÜ.

NOTICE

Exceptional maintenance work!

- ▶ Damage to the GEMÜ product
- Any maintenance work and repairs not described in these operating instructions must not be performed without consulting the manufacturer first.



The operator must carry out regular visual examinations of the products, depending on the operating conditions and the potentially hazardous situations, in order to prevent leakage and damage.

1. Have servicing and maintenance work performed by trained personnel.
2. Wear appropriate protective gear as specified in the plant operator's guidelines.
3. Disconnect from power supply.
4. Shut off plant or plant component.
5. Secure plant or plant component against recommissioning.
6. Depressurize the plant or plant component.
7. Actuate products that are always in the same position four times a year.

15.1 Cleaning the product

- Clean the product with a damp cloth.
- Do **not** clean the product with a high pressure cleaning device.

15.2 Replace actuator

 DANGER	
	<p>Do not open the actuator!</p> <ul style="list-style-type: none"> ▶ Risk of severe injury or death! ▶ Manufacturer's warranty will be voided.

NOTICE
<ul style="list-style-type: none"> ▶ Assembly information for the actuators can be found in the separately enclosed assembly instructions.

Tools required:

- Hexagon wrench WAF 5
- Open-end wrench WAF 8

15.2.1 Removing the actuator from the valve body

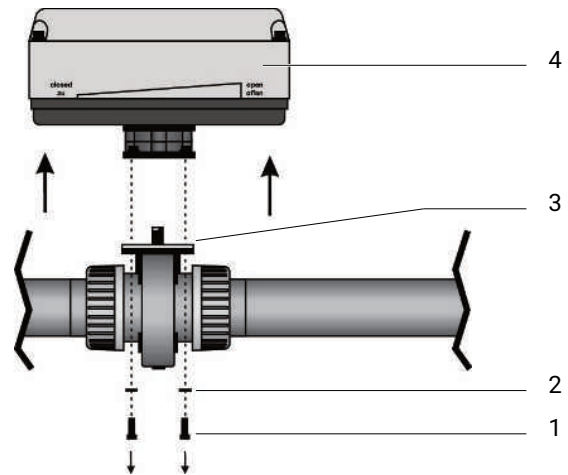

1. Depressurize and drain the plant or plant component.
 2. Move the butterfly valve to the closed position.
 3. Disconnect the electrical wiring.
 4. Unscrew the hexagon screws 1.
 5. Keep the washers 2 in a safe place.
 6. Pull the actuator 4 off the valve body 3.
- ⇒ The actuator is removed.

NOTICE
<p>Contamination</p> <ul style="list-style-type: none"> ▶ After disassembly, clean all parts of contamination (do not damage the parts during cleaning). Check parts for potential damage, replace if necessary (only use genuine parts from GEMÜ).

15.2.2 Fitting the actuator on the valve body

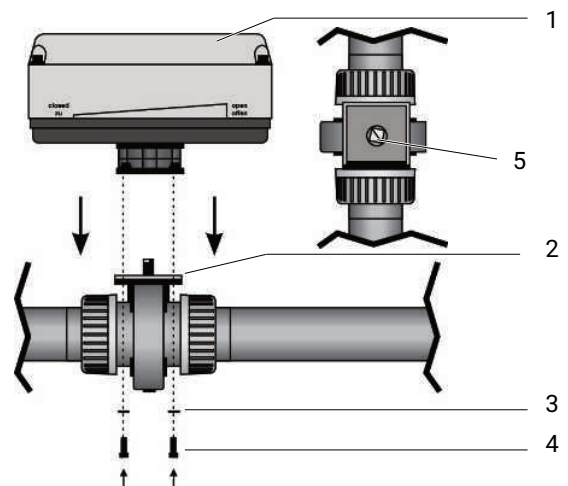

1. Read off the position of the butterfly disc at groove 5 and compare it with the position indicator; if necessary, turn the butterfly disc to the correct position.
2. Put the new actuator 1 on the valve body 2.
3. Turn the actuator 1 until the hexagon screws can be inserted.
4. Screw the hexagon screws 4 with their washers 3 in until hand tight.
5. Tighten the hexagon screws diagonally.

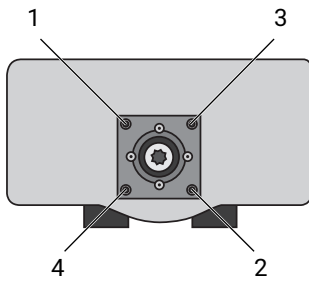

6. Connect the electrical wiring.
- ⇒ The actuator is mounted.

15.3 Replacing the shut-off seal

Tools required:

- Hexagon wrench WAF 5
- Open-end wrench WAF 8
- Bearing grease for standard version: Dow Corning Molykote® 111 Compound
- Bearing grease for silicone-free version: Klübersynth VR 69-252 N

15.3.1 Removing the shut-off seal

- ✓ The actuator is removed.

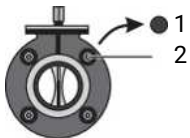

1. Remove the protective caps 1.
2. Undo the hexagon socket screws 2.
3. Keep the hexagon nuts in a safe place.
4. Press the two valve halves apart.

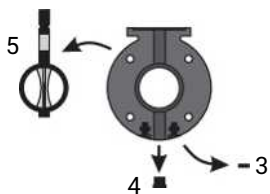

5. Keep the two square nuts 3 and protective cap 4 in a safe place.
6. Remove the disc 5 with shut-off seal.

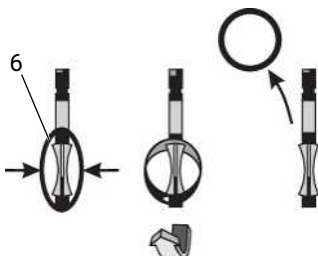

7. Squeeze the shut-off seal 6 and pull it down over the short part of the shaft towards the front.
8. Pull off the shut-off seal upwards over the long part of the shaft.

15.3.2 Mounting the shut-off seal

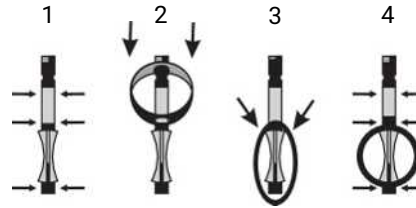

1. Lubricate the shaft of the butterfly disc above and below the disc (1).
2. Lubricate the shut-off seal in the axis/shaft area.
3. Push on the new shut-off seal with a hole over the long part of the shaft (2).
4. Squeeze the shut-off seal and slip it over the short part of the shaft (3).
5. Click the shut-off seal into position.
6. Lubricate the disc shaft above and below the shut-off seal (4).
7. Press the two valve halves apart.
8. Position the disc with shut-off seal between the two valve halves.
9. Push the two valve halves together.
10. Mount two square nuts and the protective cap.
11. Insert the hexagon socket screws and tighten with hexagon nuts diagonally until they are hand tight.
12. Press the protective caps into the valve body.

16 Troubleshooting

The product does not open/close or does not open/close fully	Actuator defective	Replace actuator
The product does not open/close or does not open/close fully	Foreign matter in the product	Remove and clean the product
The product doesn't open/close or doesn't close or doesn't close fully	Power supply not OK	Check power supply and connection, see product label
The product doesn't open/close or doesn't close or doesn't close fully	Shut-off seal incorrectly mounted or incorrect shut-off seal mounted	Replace or correctly mount the shut-off seal.
The product doesn't open or doesn't open fully	Leakage in axis/shaft area (shut-off seal has inflated)	Replace shut-off seal
The product does not close or does not close fully	Operating pressure too high	Operate the product with the operating pressure specified in the datasheet
Product leaking between actuator and body	Shut-off seal faulty	Replace shut-off seal.

Product leaking between actuator and body	Body faulty	Check body for potential damage, replace body if necessary.
Connection between body and piping is leaking	Incorrect installation	Check installation of the product in piping
Connection between body and piping leaking	O-ring missing or is contaminated or faulty	Replace O-ring.
Connection between body and piping leaking	Union nut loose	Tighten the union nut.
Body leaking	Body faulty	Check body for potential damage, replace body if necessary.
Body leaking	Shut-off seal faulty	Replace shut-off seal.
Body leaking	Shut-off seal incorrectly mounted or incorrect shut-off seal mounted	Replace or correctly mount the shut-off seal.
Body leaking	O-ring missing or is contaminated or faulty	Replace O-ring.

17 Disassembly

Disassembly is performed observing the same precautionary measures as for installation: Installation in piping (see Chapter 11, page 22).

- Disassemble in reverse order to assembly.

18 Disposal

1. Pay attention to adhered residual material and gas diffusion from penetrated media.
2. Dispose of all parts in accordance with the disposal regulations/environmental protection laws.

19 Returns

Legal regulations for the protection of the environment and personnel require that the completed and signed return delivery note is included with the dispatch documents. Returned goods can be processed only when this note is completed. If no return delivery note is included with the product, GEMÜ cannot process credits or repair work but will dispose of the goods at the operator's expense.

1. Clean the product.
2. Request a return delivery note from GEMÜ.
3. Complete the return delivery note.
4. Send the product with a completed return delivery note to GEMÜ.

20 Spare parts

20.1 Ordering spare parts

NOTICE
<p>Use of incorrect spare parts!</p> <ul style="list-style-type: none"> ▶ Damage to the GEMÜ product ▶ The manufacturer liability and guarantee will be void. ● Use only genuine parts from GEMÜ.

When ordering spare parts, please provide the following information:

1. Complete order code
2. Item number
3. Traceability number
4. Name of spare part
5. Area of use (medium, temperatures and pressures)

20.2 Spare parts overview

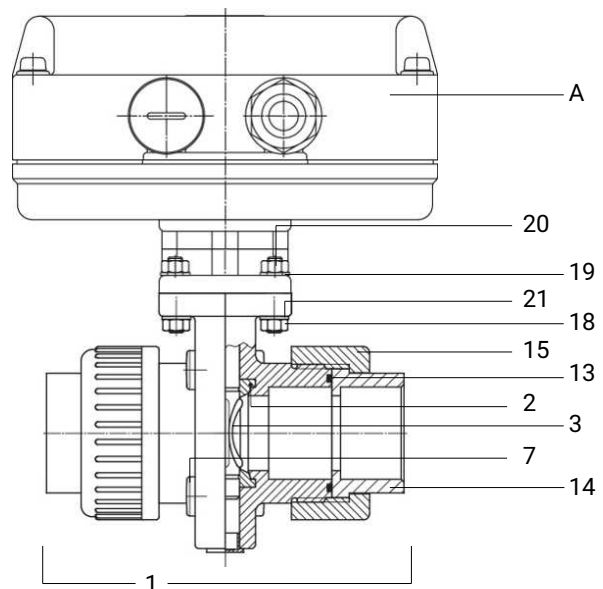

Item	Name	Order designation
1	Butterfly valve body, complete	K410
2	Shut-off seal	410 SLN
3	Butterfly disc, PP	410 SDS
7	Protective cap	410 SVK
13	O-ring	410 SOR/410 SCK
14	Insert	410 SCK
15	Union nut	410 SCK
18	Bolt	410 SVK
19	Washer	410 SVK
20	Nut	410 SVK
21	Spring washer	410 SVK
A	Actuator	9428
–	Hirschmann N6RFFS connection socket	1218 000 Z 0011

Item	Name	Order designation
–	Harting Han® 7D connection socket	1218 000 Z 0001

21 EU Declaration of Incorporation

Version 1.0

GEMÜ**Original EU-Einbauerklärung**
EU Declaration of Incorporation

Wir, die Firma

We, the company

GEMÜ Gebr. Müller Apparatebau GmbH & Co. KG
Gert-Müller-Platz 1
74635 Kupferzell
Deutschland

erklären hiermit in alleiniger Verantwortung, dass die nachfolgend bezeichneten Produkte den Vorschriften der genannten Richtlinien entspricht.

hereby declare under our sole responsibility that the below-mentioned products complies with the regulations of the mentioned Directives.

Produkt: GEMÜ 423**Product:** GEMÜ 423**Produktname:** Elektromotorisch betätigte Absperrklappe**Product name:** Motorized butterfly valve

Inbetriebnahme der unvollständigen Maschine ist nur zulässig, wenn die Gesamtmaschine den Anforderungen der Maschinenrichtlinie 2006/42/EG entspricht.

Commissioning of the incomplete machine is only permitted if the complete machine complies with the requirements of the Machinery Directive 2006/42/EC.

Richtlinien/Verordnungen:**Directives/Regulations:**MD 2006/42/EG¹⁾**Folgende harmonisierte Normen (oder Teile hieraus) wurden angewandt:****The following harmonized standards (or parts thereof) have been applied:**

EN ISO 12100:2010

Folgende grundlegenden Sicherheits- und Gesundheitsschutzanforderungen der EG-Maschinenrichtlinie 2006/42/EG, Anhang I wurden angewandt und eingehalten:

Folgende grundlegenden Sicherheits- und Gesundheitsschutzanforderungen der EG-Maschinenrichtlinie 2006/42/EG, Anhang I wurden angewandt und eingehalten:

1.1.2.; 1.1.3.; 1.1.5.; 1.3.2.; 1.3.3.; 1.3.4.; 1.3.7.; 1.3.8.; 1.5.13.; 1.5.3.; 1.5.5.; 1.5.6.; 1.5.7.; 1.5.8.; 1.6.1.; 1.6.3.; 1.6.5.; 1.7.1.; 1.7.1.1.; 1.7.2.; 1.7.3.; 1.7.4.; 1.7.4.1.; 1.7.4.2.; 1.7.4.3.

¹⁾ MD 2006/42/EG**Bemerkungen:**

Ferner wird erklärt, dass die speziellen technischen Unterlagen gemäß Anhang VII Teil B erstellt wurden.

Der Hersteller verpflichtet sich, einzelstaatlichen Stellen auf begründetes Verlangen die speziellen technischen Unterlagen zu der unvollständigen Maschine zu übermitteln. Diese Übermittlung erfolgt elektronisch.

Die gewerblichen Schutzrechte bleiben hiervon unberührt!

¹⁾ MD 2006/42/EG**Remarks:**

It is also declared that the specific technical documentation has been prepared in accordance with Annex VII, Part B.

The manufacturer undertakes to provide national authorities with the specific technical documentation relating to the partly completed machinery upon reasoned request. This documentation shall be provided electronically.

Industrial property rights remain unaffected by this!



i.V. M. Barghoorn
Leiter Globale Technik
Ingelfingen, 24.03.2026

GEMÜ Gebr. Müller Apparatebau GmbH & Co. KG
Gert-Müller-Platz 1, 74635 Kupferzell, Deutschland

www.gemu-group.com
info@gemu.de

22 EU Declaration of Conformity



Version 1.0



EU-Konformitätserklärung

EU Declaration of Conformity

Wir, die Firma

We, the company

GEMÜ Gebr. Müller Apparatebau GmbH & Co. KG
Gert-Müller-Platz 1
74635 Kupferzell
Deutschland

erklären hiermit in alleiniger Verantwortung, dass die nachfolgend bezeichneten Produkte den Vorschriften der genannten Richtlinien entspricht.

hereby declare under our sole responsibility that the below-mentioned products complies with the regulations of the mentioned Directives.

Produkt: GEMÜ 423

Product: GEMÜ 423

Produktname: Elektromotorisch betätigte Absperrklappe

Product name: Motorized butterfly valve

Richtlinien/Verordnungen:

Directives/Regulations:

PED 2014/68/EU¹⁾

Folgende harmonisierte Normen (oder Teile hieraus) wurden angewandt:

The following harmonized standards (or parts thereof) have been applied:

EN ISO 16136:2006/A1:2019

¹⁾ PED 2014/68/EU

Einteilung gemäß Druckgeräterichtlinie 2014/68/EU, Artikel 4 und Anhang II:
Fluidklasse 1 (gasförmig oder flüssig),
Diagramm 6, Kategorie I
Instabile Gase sind ausgeschlossen.

Notifizierte Stelle:
TÜV Rheinland Industrie Service GmbH
Am Grauen Stein 1
51105 Köln

Kennnummer der notifizierten Stelle: 0035

Nr. des QS-Zertifikats: 01 202 926/Q-02 0036

Angewandte(s) Konformitätsbewertungsverfahren: Modul H

Hinweis für Produkte mit einer Nennweite ≤ DN 25:

Die Produkte werden entwickelt und produziert nach GEMÜ eigenen Verfahrensangeweisungen und Qualitätsstandards, welche die Forderungen der ISO 9001 und der ISO 14001 erfüllen. Die Produkte dürfen gemäß Artikel 4, Absatz 3 der Druckgeräterichtlinie 2014/68/EU keine CE-Kennzeichnung tragen.

¹⁾ PED 2014/68/EU

Classification in accordance with the Pressure Equipment Directive 2014/68/EU, Article 4 and Annex II:
Fluid class 1 (gaseous or liquid),
Diagram 6, Category I
Unstable gases are excluded.

Notified body:
TÜV Rheinland Industrie Service GmbH
Am Grauen Stein 1
51105 Cologne

Identification number of the notified body: 0035

QA certificate number: 01 202 926/Q-02 0036

Applied conformity assessment procedures: Module H

Note for products with a nominal size ≤ DN 25:

The products are developed and manufactured in accordance with GEMÜ's own process instructions and quality standards, which meet the requirements of ISO 9001 and ISO 14001. In accordance with Article 4, Paragraph 3 of the Pressure Equipment Directive 2014/68/EU, the products are not permitted to bear the CE mark.

i.v. M. Barghoorn
Leiter Globale Technik
Kupferzell, 24.03.2026

GEMÜ Gebr. Müller Apparatebau GmbH & Co. KG
Gert-Müller-Platz 1, 74635 Kupferzell, Deutschland

www.gemu-group.com
info@gemu.de

23 EU Declaration of Conformity



Version 1.0



EU-Konformitätserklärung
EU Declaration of Conformity

Wir, die Firma

We, the company

GEMÜ Gebr. Müller Apparatebau GmbH & Co. KG
Gert-Müller-Platz 1
74635 Kupferzell
Deutschland

erklären hiermit in alleiniger Verantwortung, dass die nachfolgend bezeichneten Produkte den Vorschriften der genannten Richtlinien entspricht.

hereby declare under our sole responsibility that the below-mentioned products complies with the regulations of the mentioned Directives.

Produkt: GEMÜ 423

Product: GEMÜ 423

Produktname: Elektromotorisch betätigte Absperrklappe

Product name: Motorized butterfly valve

Richtlinien/Verordnungen:

Directives/Regulations:

EMC 2014/30/EU

Folgende harmonisierte Normen (oder Teile hieraus) wurden angewandt:

The following harmonized standards (or parts thereof) have been applied:

EN 61000-6-4:2019

i.v. M. Barghoorn
Leiter Globale Technik
Kupferzell, 24.03.2026

GEMÜ Gebr. Müller Apparatebau GmbH & Co. KG
Gert-Müller-Platz 1, 74635 Kupferzell, Deutschland

www.gemu-group.com
info@gemu.de



GEMÜ Gebr. Müller Apparatebau GmbH & Co. KG
Gert-Müller-Platz 1, 74635 Kupferzell, Germany
Phone +49 (0) 7940 1230 · info@gemue.de
www.gemu-group.com

Subject to alteration

03.2026 | 88928564