

GEMÜ C33 HydraLine

Pressure transducer

EN

Operating instructions



further information
webcode: GW-C33



All rights including copyrights or industrial property rights are expressly reserved.

Keep the document for future reference.

© GEMÜ Gebr. Müller Apparatebau GmbH & Co. KG
22.01.2026

Contents

| | |
|---|-----------|
| 1 General information | 4 |
| 1.1 Information | 4 |
| 1.2 Symbols used | 4 |
| 1.3 Warning notes | 4 |
| 2 Safety information | 4 |
| 3 Product description | 5 |
| 3.1 Construction | 5 |
| 3.2 Description | 5 |
| 3.3 Function | 5 |
| 3.4 Product label | 5 |
| 4 Intended use | 5 |
| 5 Order data | 6 |
| 6 Technical data | 7 |
| 6.1 Medium | 7 |
| 6.2 Temperature | 7 |
| 6.3 Mechanical data | 7 |
| 6.4 Electrical data for measuring transducer | 7 |
| 6.5 Pressure | 7 |
| 6.6 Product conformity | 8 |
| 7 Dimensions | 8 |
| 7.1 In-Line (Code L) | 8 |
| 7.2 Dead-end (Code E) | 9 |
| 8 Manufacturer's information | 10 |
| 8.1 Packaging | 10 |
| 8.2 Transport | 10 |
| 8.3 Storage | 10 |
| 8.4 Delivery | 10 |
| 9 Installation in piping | 10 |
| 9.1 Preparing for installation | 10 |
| 9.2 Installation with flare connections | 11 |
| 9.3 Installation position | 11 |
| 9.4 Mounting point | 11 |
| 9.4.1 In-line version | 12 |
| 9.4.2 Dead-end version | 12 |
| 9.5 After installation | 12 |
| 10 Electrical connection | 13 |
| 11 Commissioning | 14 |
| 12 Potential faults | 14 |
| 13 Inspection and maintenance | 14 |
| 13.1 Replacing the pressure gauge | 14 |
| 14 Removal from piping | 14 |
| 15 Disposal | 14 |
| 16 Returns in the event of a complaint | 15 |
| 17 Manufacturer's declaration according to the Pres- sure Equipment Directive 2014/68/EU | 16 |
| 18 EU Declaration of Conformity in accordance with 2014/30/EU (EMC Directive) | 17 |

1 General information

1.1 Information

- The descriptions and instructions apply to the standard versions. For special versions not described in this document the basic information contained herein applies in combination with any additional special documentation.
- Correct installation, operation, maintenance and repair work ensure faultless operation of the product.
- Should there be any doubts or misunderstandings, the German version is the authoritative document.
- Contact us at the address on the last page for staff training information.

1.2 Symbols used

The following symbols are used in this document:

| Symbol | Meaning |
|--------|-----------------------|
| ● | Tasks to be performed |
| ► | Response(s) to tasks |
| – | Lists |

1.3 Warning notes

Wherever possible, warning notes are organised according to the following scheme:

| SIGNAL WORD | |
|---|--|
| Possible symbol for the specific danger | Type and source of the danger ► Possible consequences of non-observance. ● Measures for avoiding danger. |

Warning notes are always marked with a signal word and sometimes also with a symbol for the specific danger.

The following signal words and danger levels are used:

|  DANGER | |
|--|---|
|  | Imminent danger! ► Non-observance can cause death or severe injury. |
|  WARNING | |
|  | Potentially dangerous situation! ► Non-observance can cause death or severe injury. |
|  CAUTION | |
|  | Potentially dangerous situation! ► Non-observance can cause moderate to light injury. |

NOTICE



Potentially dangerous situation!

- Non-observance can cause damage to property.

The following symbols for the specific dangers can be used within a warning note:

| Symbol | Meaning |
|---|-----------------------|
|  | Danger – high voltage |

2 Safety information

The safety information in this document refers only to an individual product. Potentially dangerous conditions can arise in combination with other plant components, which need to be considered on the basis of a risk analysis. The operator is responsible for the production of the risk analysis and for compliance with the resulting precautionary measures and regional safety regulations.

The document contains fundamental safety information that must be observed during commissioning, operation and maintenance. Non-compliance with these instructions may cause:

- Personal hazard due to electrical, mechanical and chemical effects
- Hazard to nearby equipment
- Failure of important functions
- Hazard to the environment due to the leakage of dangerous materials

The safety information does not take into account:

- Unexpected incidents and events, which may occur during installation, operation and maintenance
- Local safety regulations which must be adhered to by the operator and by any additional installation personnel

Prior to commissioning:

1. Transport and store the product correctly.
2. Do not paint the bolts and plastic parts of the product.
3. Carry out installation and commissioning using trained personnel.
4. Provide adequate training for installation and operating personnel.
5. Ensure that the contents of the document have been fully understood by the responsible personnel.
6. Define the areas of responsibility.
7. Observe the safety data sheets.
8. Observe the safety regulations for the media used.

During operation:

9. Keep this document available at the place of use.
10. Observe the safety information.
11. Operate the product in accordance with this document.
12. Operate the product in accordance with the specifications.
13. Maintain the product correctly.
14. Do not carry out any maintenance work and repairs not described in this document without consulting the manufacturer first.

In cases of uncertainty:

15. Consult the nearest GEMÜ sales office.

3 Product description**3.1 Construction**

| Item | Name | Material |
|------|---------------------------------|------------------|
| 1 | Cable* | FEP encapsulated |
| 2 | Housing* | PVDF, FKM |
| 3 | Housing (separation of media)** | PTFE |
| 4 | Body** | PTFE |

* not media wetted

** media wetted

3.2 Description

The GEMÜ C33 HydraLine electronic pressure gauge comprises a PTFE body and a housing made of PTFE, PVDF and FKM. It has a ceramic pressure measurement cell which is separated from the process medium by an innovative new sealing concept. This means the process medium only comes into contact with PTFE. The GEMÜ C33 HydraLine has a leak detection hole for easy leakage detection and can be integrated directly into the piping system via flare unions.

3.3 Function

The product is used for pressure measurement in plants that require a high level of purity and resistance, such as in the semiconductor industry.

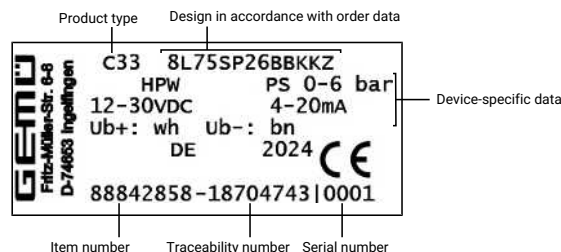
3.4 Product label

The month of manufacture is encoded in the traceability number and can be obtained from GEMÜ. The product was manufactured in Germany.

4 Intended use

⚠ DANGER

Danger of explosion!

- ▶ Risk of death or severe injury
- Do **not** use the product in potentially explosive zones.

⚠ WARNING

Improper use of the product!

- ▶ Risk of severe injury or death
- ▶ Manufacturer liability and guarantee will be void.
- Only use the product in accordance with the operating conditions specified in the contract documentation and in this document.

- The product must not be operated at excessive pressures.
- The product must not be used as a load-bearing part within a plant for supporting/fixing piping.
- The product is suitable for corrosive, inert, gaseous and liquid media which have no negative impact on the physical and chemical properties of the valve body and seal material.

5 Order data

The order data provide an overview of standard configurations.

Please check the availability before ordering. Other configurations available on request.

Order codes

| 1 Type | Code |
|---|------|
| Pressure gauge with ceramic pressure sensor | C33 |
| 2 Connection size | Code |
| 1/4", international code: 4 | 4 |
| 3/8", international code: 6 | 6 |
| 1/2", international code: 8 | 8 |
| 3/4", international code: 12 | 12 |
| 1", international code: 16 | 16 |
| 3 Mounting version | Code |
| Dead-end | E |
| In-line | L |
| 4 Connection type | Code |
| Flare connection with CPFA union nut | 73 |
| Flare connection with PVDF union nut | 75 |
| Flare connection with PFA union nut | 77 |
| Nexus Connect connection with PFA union nut | NX |

| 5 Housing material | Code |
|--|------|
| PTFE polytetrafluoroethylene, white | SP |
| 6 Diaphragm material | Code |
| Modified PTFE, polytetrafluoroethylene | 26 |
| 7 Unit | Code |
| bar | B |
| psi | P |
| 8 Measuring range | Code |
| 0–30 psi, 0.0–2.5 bar | BJ |
| 0–100 psi, 0.0–6.0 bar | BK |
| 9 Connection type | Code |
| Cable outlet with 2 m flying lead, (FEP encapsulated), IP 67 | K |
| 10 Display | Code |
| Without | Z |
| 11 High Purity version | Code |
| High Purity, white | HPW |

Order example

| Ordering option | Code | Description |
|------------------------|------|--|
| 1 Type | C33 | Pressure gauge with ceramic pressure sensor |
| 2 Connection size | 8 | 1/2", international code: 8 |
| 3 Mounting version | L | In-line |
| 4 Connection type | 73 | Flare connection with CPFA union nut |
| 5 Housing material | SP | PTFE polytetrafluoroethylene, white |
| 6 Diaphragm material | 26 | Modified PTFE, polytetrafluoroethylene |
| 7 Unit | B | bar |
| 8 Measuring range | BK | 0–100 psi, 0.0–6.0 bar |
| 9 Connection type | K | Cable outlet with 2 m flying lead, (FEP encapsulated), IP 67 |
| 10 Display | Z | Without |
| 11 High Purity version | HPW | High Purity, white |

6 Technical data

6.1 Medium

Working medium: Corrosive, inert, gaseous and liquid media which have no negative impact on the physical and chemical properties of the body and seal material.

6.2 Temperature

Media temperature: 0 – 80 °C

Ambient temperature: 0 – 60 °C

6.3 Mechanical data

Installation position: Optional

Flow direction: Optional

Protection class: IP 67

Mounting version: In-Line and Dead-End

Connection cable: 2 m, flying lead, FEP encapsulated, bend radius \geq 20 mm

Weight: 500 g (In-Line 1/2")

6.4 Electrical data for measuring transducer

Supply voltage: 12–30 V DC

Output signal: 4–20 mA, two-wire

Error of measurement: \pm 1% FS (100 psi and 6 bar, according to DIN EN 61298-2)
 \pm 1.5% FS (30 psi and 2.5 bar, according to DIN EN 61298-2)

Jump response time:

| Jump | response time |
|---------------------------|-----------------|
| 10–90% of measuring range | Typically 70 ms |
| 5–15% of measuring range | Typically 50 ms |
| 45–55% of measuring range | Typically 50 ms |
| 85–95% of measuring range | Typically 50 ms |

Duty cycle: Continuous duty

Reverse polarity protection: yes

Short-circuit resistance: yes

6.5 Pressure

Measuring range: 0–30 psi (code P and JK)
 0–2.5 bar (code B and JK)
 0–100 psi (code P and BK)
 0–6 bar (code B and BK)

6.6 Product conformity

Pressure Equipment Directive: 2014/68/EU

EMC Directive: 2014/30/EU

RoHS Directive: 2011/65/EU

7 Dimensions

7.1 In-Line (Code L)

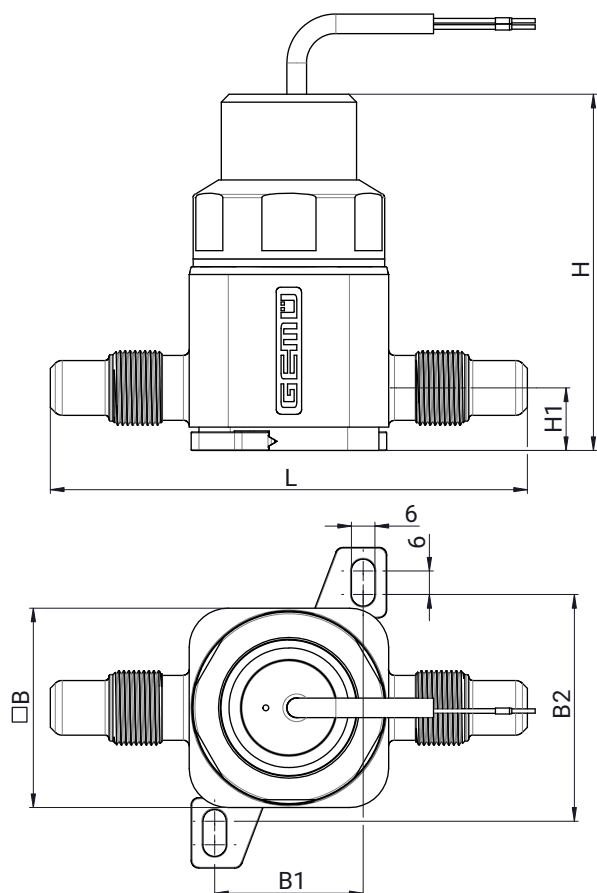

| Connection | B | B1 | B2 | H | H1 | L |
|-------------|------|------|------|-------|-------|-------|
| 3/8" Flare* | 51.0 | 38.0 | 61.0 | 88.6 | 15.0 | 118.0 |
| 1/2" Flare* | 51.0 | 38.0 | 61.0 | 91.1 | 16.0 | 122.0 |
| 3/4" Flare* | 51.0 | 38.0 | 61.0 | 98.1 | 19.0 | 122.0 |
| 1" Flare* | 55.0 | 43.0 | 65.0 | 106.8 | 25.0 | 165.0 |
| 3/8" Nexus* | 51.0 | 38.0 | 61.0 | 90.6 | 17.0 | 81.0 |
| 1/2" Nexus* | 51.0 | 38.0 | 61.0 | 94.1 | 19.0 | 86.0 |
| 3/4" Nexus* | 51.0 | 38.0 | 61.0 | 102.1 | 23.0 | 95.0 |
| 1" Nexus* | 55.0 | 43.0 | 65.0 | 110.1 | 28.42 | 109.0 |

Dimensions in mm

* Overall dimension (installation dimension) without union nuts

7.2 Dead-end (Code E)

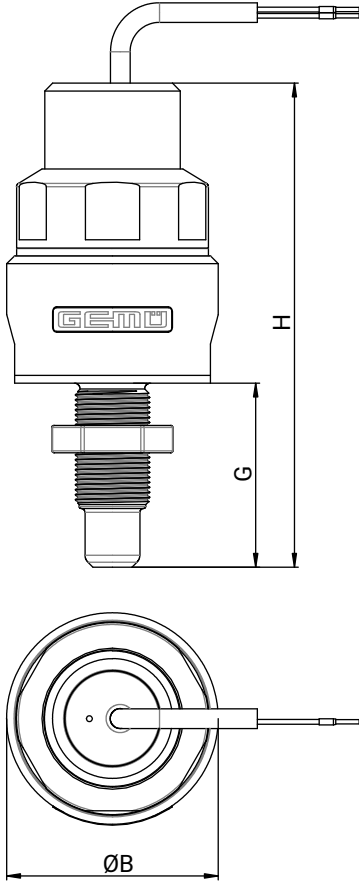

| Connection | B | G | H |
|--------------------|------|------|-------|
| 1/4" Flare* | 54.0 | 44.0 | 120.6 |
| 1/2" Flare* | 54.0 | 47.0 | 123.6 |
| 1/4" Nexus* | 54.0 | 11.0 | 87.6 |
| 1/2" Nexus* | 54.0 | 17.5 | 94.1 |

Dimensions in mm

* Overall dimension (installation dimension) without union nuts

8 Manufacturer's information

8.1 Packaging

The product is sealed (HPW version) in two plastic bags and packaged in a cardboard box. This cardboard box can be recycled as paper.

8.2 Transport

1. Only transport the product by suitable means. Do not drop. Handle carefully.
2. After the installation dispose of transport packaging material according to relevant local or national disposal regulations / environmental protection laws.

8.3 Storage

1. Store the product free from dust and moisture in its original packaging.
2. Avoid UV rays and direct sunlight.
3. Do not exceed the maximum storage temperature (see chapter "Technical data").
4. Do not store solvents, chemicals, acids, fuels or similar fluids in the same room as GEMÜ products and their spare parts.
5. Close the compressed air connections with protection caps or sealing plugs.





8.4 Delivery



- Check that all parts are present and check for any damage immediately upon receipt.



The product's performance is tested at the factory. The scope of delivery is apparent from the dispatch documents and the design from the order number.

9 Installation in piping

9.1 Preparing for installation

|  WARNING | |
|--|---|
|  | The equipment is subject to pressure! <ul style="list-style-type: none"> ► Risk of severe injury or death ● Depressurize the plant or plant component. ● Completely drain the plant or plant component. |
| | |
|  WARNING | |
|  | Corrosive chemicals! <ul style="list-style-type: none"> ► Risk of caustic burns ● Wear appropriate protective gear. ● Completely drain the plant. |
| | |

|  CAUTION | |
|--|--|
|  | Hot plant components! <ul style="list-style-type: none"> ► Risk of burns ● Only work on plant that has cooled down. |

|  CAUTION | |
|--|---|
|  | Maximum permissible pressure exceeded! <ul style="list-style-type: none"> ► Damage to the product! ● Provide for precautionary measures against exceeding the maximum permissible pressure that may be caused by pressure surges (water hammer). |

|  CAUTION | |
|--|--|
| Use as step! | |
| <ul style="list-style-type: none"> ► Damage to the product ► Risk of slipping-off ● Choose the installation location so that the product cannot be used as a foothold. ● Do not use the product as a step or a foothold. | |

| NOTICE | |
|--|--|
| Suitability of the product! | |
| <ul style="list-style-type: none"> ► The product must be appropriate for the piping system operating conditions (medium, medium concentration, temperature and pressure) and the prevailing ambient conditions. | |

NOTICE**Tools!**

- The tools required for installation and assembly are not included in the scope of delivery.
- Use appropriate, functional and safe tools.

1. Ensure the product is suitable for the relevant application.
2. Check the technical data of the product and the materials.
3. Keep appropriate tools ready.
4. Wear appropriate protective gear, as specified in the plant operator's guidelines.
5. Observe appropriate regulations for connections.
6. Have installation work carried out by trained personnel.
7. Shut off plant or plant component.
8. Secure plant or plant component against recommissioning.
9. Depressurize the plant or plant component.
10. Completely drain the plant (or plant component) and let it cool down until the temperature is below the media vaporization temperature and cannot cause scalding.
11. Correctly decontaminate, rinse and ventilate the plant or plant component.
12. Lay piping so that the product is protected against transverse and bending forces, and also from vibrations and tension.
13. Only install the product between matching aligned pipes (see chapters below).

9.2 Installation with flare connections

- For preparation and connection of the flare connections, please refer to operating instructions and assembly instructions for FlareStar.
- Depending on the ambient conditions, use resistant and suitable connection fittings.

9.3 Installation position**CAUTION**

- The product must always be mounted so that it is mechanically stress-free. Extreme tension in the pipe system can cause damage to the product.

The product must not be mounted behind an outlet valve as it can run empty otherwise. To prevent gas diffusion and formation of blisters in the medium during static or dynamic pressure measurement, the product must always be installed on the pressure side of the system pump.

If the product cannot be mounted vertically, the line in which it is mounted must always be filled. An optimal measurement is ensured if no gas bubbles can form in the measurement channel of the product.

For applications with minimal deadleg, i.e. when it must be ensured that the lines are completely drained, we recommend vertical installation of the product. If the installation position

is horizontal, remnants of liquid could remain in the product due to the geometry of the channel in the measurement channel interior.

Vibrations or mechanical stress can affect the accuracy of the product. If it is therefore necessary to additionally fix the product in place due to vibrations or mechanical movements, the product can be fixed in place using two mounting lugs.

9.4 Mounting point**NOTICE****Body has been twisted!**

- Sealing adhesive is destroyed.
- Warranty expired.
- **Do not** twist the body.
- Only use the mounting facilities shown below.

NOTICE**Hollow bolt has been twisted!**

- Sealing adhesive is destroyed.
- Tightness is affected.
- Measuring accuracy is affected.
- Electronics will be damaged.
- **Do not** twist the hollow bolt.

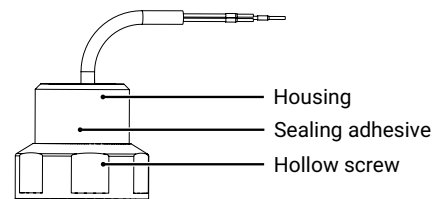
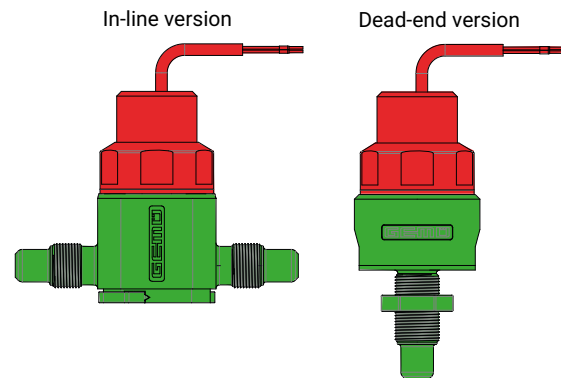
**Overview of rotatable/non-rotatable parts:**

| | |
|--------------|---------------------------------|
| Green | Rotatable (including union nut) |
| Red | Non-rotatable |

9.4.1 In-line version

For the in-line version, GEMÜ recommends fastening to the mounting lugs.

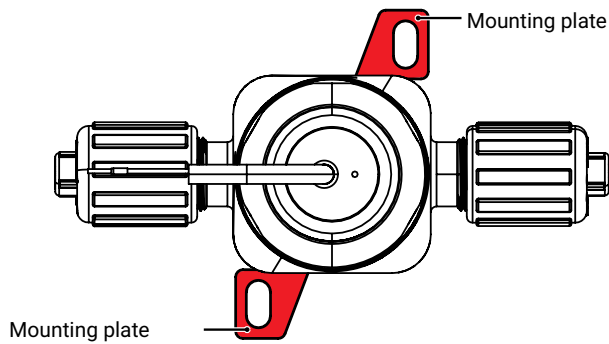
**9.4.2 Dead-end version**

For the dead-end version, GEMÜ recommends fastening via a mounting plate.

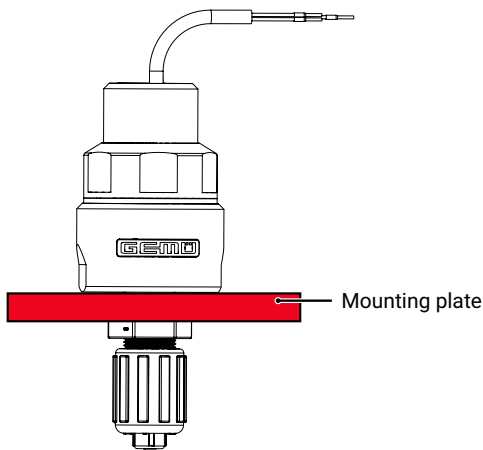
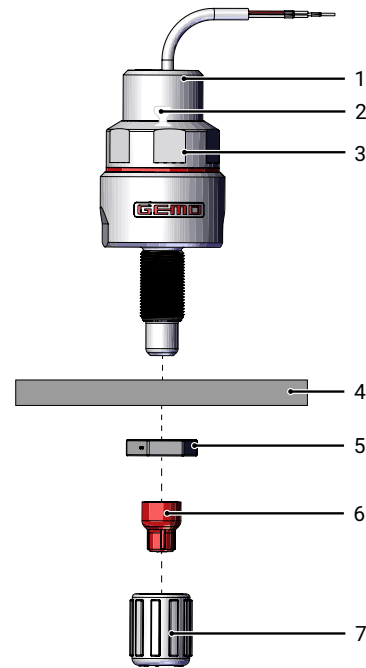
**9.4.2.1 Mounting the mounting plate**

| Item | Designation |
|------|------------------|
| 1 | Body |
| 2 | Sealing adhesive |
| 3 | Hollow bolt |
| 4 | Mounting plate |
| 5 | Lock nut |
| 6 | Protective cap |
| 7 | Union nut |

1. Unscrew union nut **7**.
2. Remove protective cap **6**.
3. Unscrew lock nut **5**.
4. Push mounting plate **4** over the thread.
5. Screw lock nut **5** over the thread until mounting plate **4** is fixed in place and lock it with the body (note the recesses for the wrench).
6. Re-attach union nut **7**.

9.5 After installation

- Re-attach or reactivate all safety and protective devices.

10 Electrical connection

⚠ CAUTION

Damage to the product!

- ▶ Short-circuit.
- Connect/reverse the polarity of the product correctly.

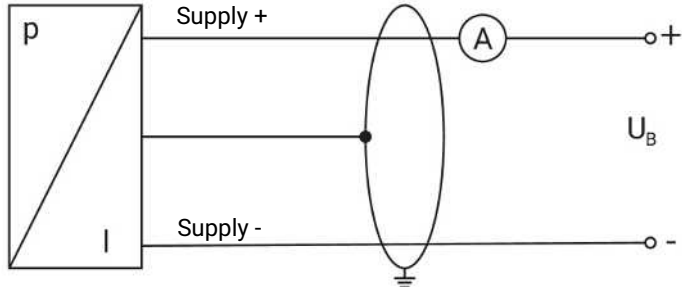

| Strand colour | Function | Supply voltage | Analogue signal |
|---------------|----------|----------------|-----------------|
| White | Supply + | 12–30 V DC | 4–20 mA |
| Brown | Supply - | | |
| Green-yellow | Shield | - | - |

11 Commissioning

⚠ WARNING



Corrosive chemicals!

- ▶ Risk of caustic burns
- Wear appropriate protective gear.
- Completely drain the plant.

⚠ CAUTION

Cleaning agent!

- ▶ Damage to the GEMÜ product
- The plant operator is responsible for selecting the cleaning material and performing the procedure.

⚠ CAUTION

Excessive pressures/temperatures!

- ▶ Breakage of the valve body.
- Only operate the product within the pressure/temperature limits specified in datasheet.

1. Install the product correctly.
2. Check the product for visible defects.
 - ⇒ The hollow bolt of the measurement device, which is sealed with a sealing adhesive, must not be loosened under any circumstances. This leads to a destruction of the measuring arrangement and process medium leaking.
3. Flush the piping system for new plants and after repair work (the product must be fully open).
 - ⇒ Harmful foreign matter has been removed.
 - ⇒ The product is ready for use.
4. Operate the product within the specification (see technical data).

12 Potential faults

Leak detection hole:

There is a leak detection hole (opposite the GEMÜ logo). If working medium escapes from the leak detection hole, the product must be replaced.

Wire breakage safety:

The input signal of 4–20 mA is designed such that the product recognises at 0 mA if a wire in the cabling between the product and the control unit is interrupted (cable break or similar).

Water hammers:

Water hammers can damage the product. This can result in incorrect measured values. Ensure that the product is subjected to as few water hammers as possible.

Incorrect supply voltage:

If the product is operated outside the voltage specifications in the datasheet, this may result in incorrect measured values.

13 Inspection and maintenance

The operator must carry out regular visual examinations of the products, depending on the operating conditions and the potentially hazardous situations, in order to prevent leakage and damage.

The hollow bolt of the measurement device, which is sealed with a sealing adhesive, must **not** be loosened under any circumstances. This leads to a destruction of the measuring arrangement and process medium leaking.

1. Have servicing and maintenance work performed by trained personnel.
2. Wear appropriate protective gear in accordance with the plant operator's guidelines.
3. Shut off the plant or plant component.
4. Secure the plant or plant component against recommissioning.
5. Depressurize the plant or plant component.

13.1 Replacing the pressure gauge

1. Observe the safety information from commissioning.
2. Switch off the electrical system.
3. Undo electrical connections.
4. Insert new pressure gauge.
5. Adopt the settings of the previous pressure gauge (optional).

14 Removal from piping

⚠ WARNING



Corrosive chemicals!

- ▶ Risk of caustic burns
- Wear appropriate protective gear.
- Completely drain the plant.

1. Remove in reverse order to installation.
2. Unscrew the electrical wiring.
3. Dismantle the product. Observe the warnings and safety information as per commissioning.
 - ⇒ The operator must ensure the product is removed safely.

15 Disposal

1. Pay attention to adhered residual material and gas diffusion from penetrated media.
 - ⇒ Observe the safety information from commissioning.
2. Dispose of all parts according to relevant local or national disposal regulations/environmental protection laws.
3. Dispose of electronic components separately.

16 Returns in the event of a complaint

Legal regulations for the protection of the environment and personnel require that the completed and signed return delivery note is enclosed with the dispatch documents. Returned goods can only be processed if this note is completed. If no return delivery note is enclosed with the product, no credit will be provided and no repair work will be carried out, and the product will instead be disposed of at your expense.

1. Clean the product (pay particular attention to the process connections area where medium residue can stick. This is especially important when the medium is hazardous to health, corrosive or has gas diffusions, etc.)
2. Request a return delivery note from GEMÜ.
3. Complete the return delivery note in full.
4. Send the product to GEMÜ together with a completed return delivery note.

17 Manufacturer's declaration according to the Pressure Equipment Directive 2014/68/EU



Manufacturer's declaration

according to the Pressure Equipment Directive 2014/68/EU

We, the company

GEMÜ Gebr. Müller Apparatebau GmbH & Co. KG
Fritz-Müller-Strasse 6-8
74653 Ingelfingen-Criesbach, Germany

declare that the below-mentioned product is designed and manufactured in compliance with sound engineering practice according to Article 4, Paragraph 3 of the Pressure Equipment Directive 2014/68/EU.

Product: GEMÜ C33

Product name: Pressure transducer

The product has been developed and produced according to GEMÜ's in-house process instructions and standards of quality which comply with the requirements of ISO 9001 and ISO 14001. According to Article 4, Paragraph 3 of the Pressure Equipment Directive 2014/68/EU, this product must not be identified by a CE-marking.

Other applied technical standards / Remarks:

- EN ISO 16138:2006/A1:2019

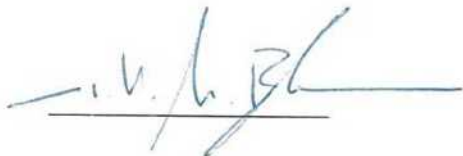

M. Barghoorn
Head of Global Technics

Ingelfingen, 30/04/2024

18 EU Declaration of Conformity in accordance with 2014/30/EU (EMC Directive)



EU Declaration of Conformity

in accordance with 2014/30/EU (EMC Directive)

We, the company

GEMÜ Gebr. Müller Apparatebau GmbH & Co. KG
Fritz-Müller-Strasse 6-8
74653 Ingelfingen-Criesbach, Germany

hereby declare under our sole responsibility that the below-mentioned product complies with the regulations of the above-mentioned Directive.

| | |
|---|--|
| Product: | GEMÜ C33 |
| Product name: | Pressure transducer |
| The following harmonized standards (or parts thereof) have been applied: | EN IEC 61326-1:2021 EN IEC 61326-2-3:2021 |

A handwritten signature in blue ink, appearing to read 'M. Barghoorn', is written over a horizontal line.

M. Barghoorn
Head of Global Technics

Ingelfingen, 30/04/2024



GEMÜ Gebr. Müller Apparatebau GmbH & Co. KG
Gert-Müller-Platz 1, 74635 Kupferzell, Germany
Phone +49 (0) 7940 1230 · info@gemue.de
www.gemu-group.com

Subject to alteration

01.2026 | 88844881